

PA DOOR DETAIL ON METAL CLADDING

FOR SHEDS AND OUTBUILDINGS ONLY

DETAIL LIST		Revision	Date
00 / 06	COVER SHEET		
01 / 06	OUTWARDS OPENING DOOR DETAIL - TRAPEZOIDAL	1.1	JUNE 2025
02 / 06	OUTWARDS OPENING DOOR DETAIL ON METCLAD 850	1.1	JUNE 2025
03 / 06	ALTERNATIVE OUTWARDS OPENING DOOR DETAIL METCLAD 850	1.1	JUNE 2025
04 / 06	INWARDS OPENING DOOR DETAIL - TRAPEZOIDAL	1.1	JUNE 2025
05 / 06	INWARDS OPENING DOOR DETAIL ON METCLAD 850	1.1	JUNE 2025
06 / 06	ALTERNATIVE INWARDS OPENING DOOR DETAIL METCLAD 850	1.1	JUNE 2025

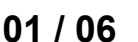

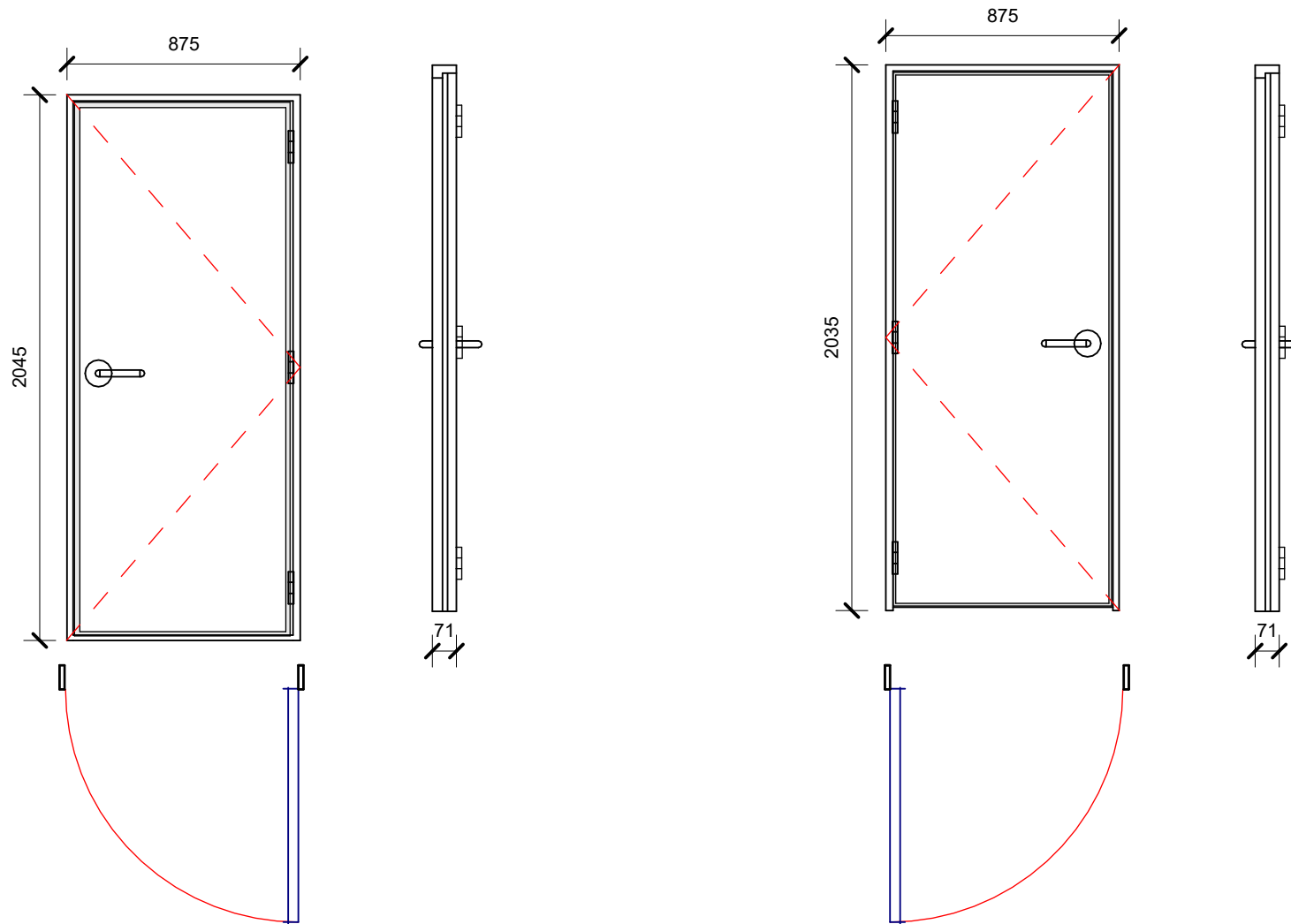

STANDARD DOOR FULL FRAME - RIGHT HAND

CUT SIZE (HOLE IN THE WALL)
HEIGHT = 2050mm
WIDTH = 885mm

BOX SIZE
HEIGHT = 2045mm
WIDTH = 875mm

STANDARD DOOR NO BOTTOM FRAME - LEFT HAND

CUT SIZE (HOLE IN THE WALL)
HEIGHT = 2040mm
WIDTH = 885mm

BOX SIZE
HEIGHT = 2035mm
WIDTH = 875mm

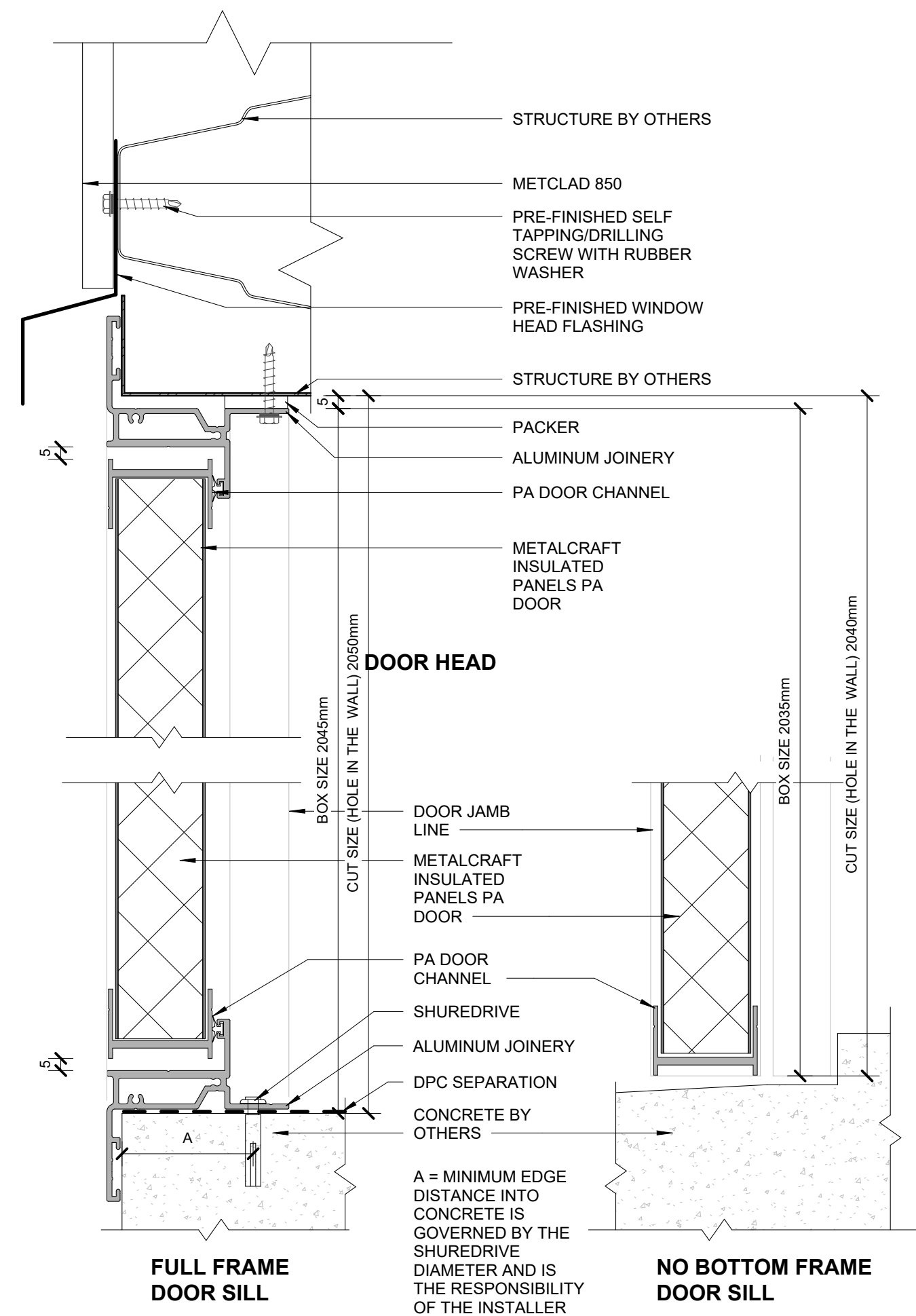
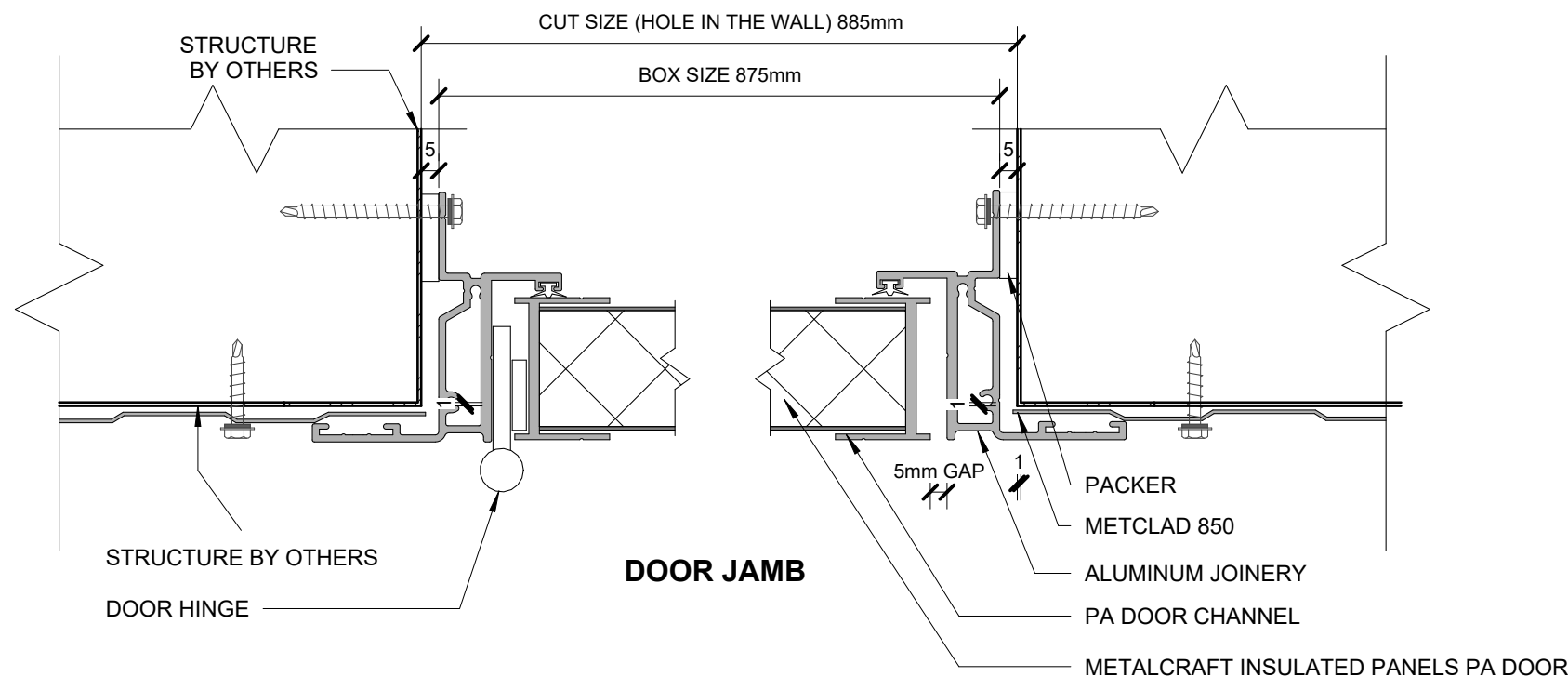

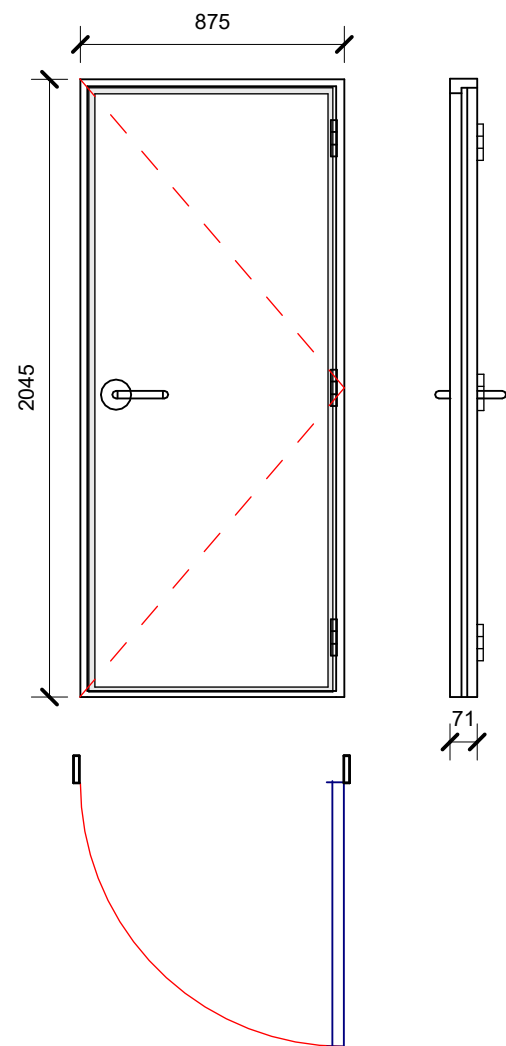

STANDARD DOOR FULL FRAME - RIGHT HAND

CUT SIZE (HOLE IN THE WALL)
HEIGHT = 2050mm
WIDTH = 885mm

BOX SIZE
HEIGHT = 2045mm
WIDTH = 875mm

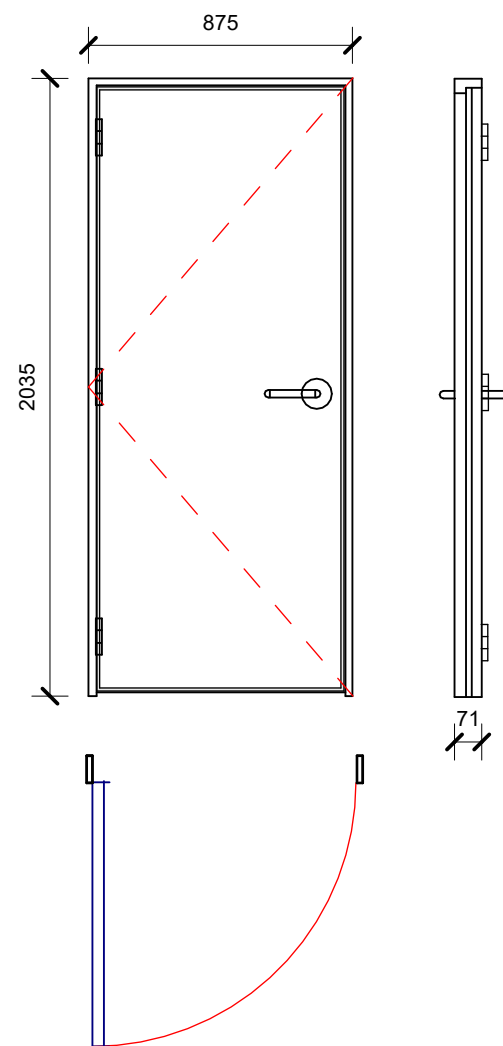

STANDARD DOOR NO BOTTOM FRAME - LEFT HAND

CUT SIZE (HOLE IN THE WALL)
HEIGHT = 2040mm
WIDTH = 885mm

BOX SIZE
HEIGHT = 2035mm
WIDTH = 875mm

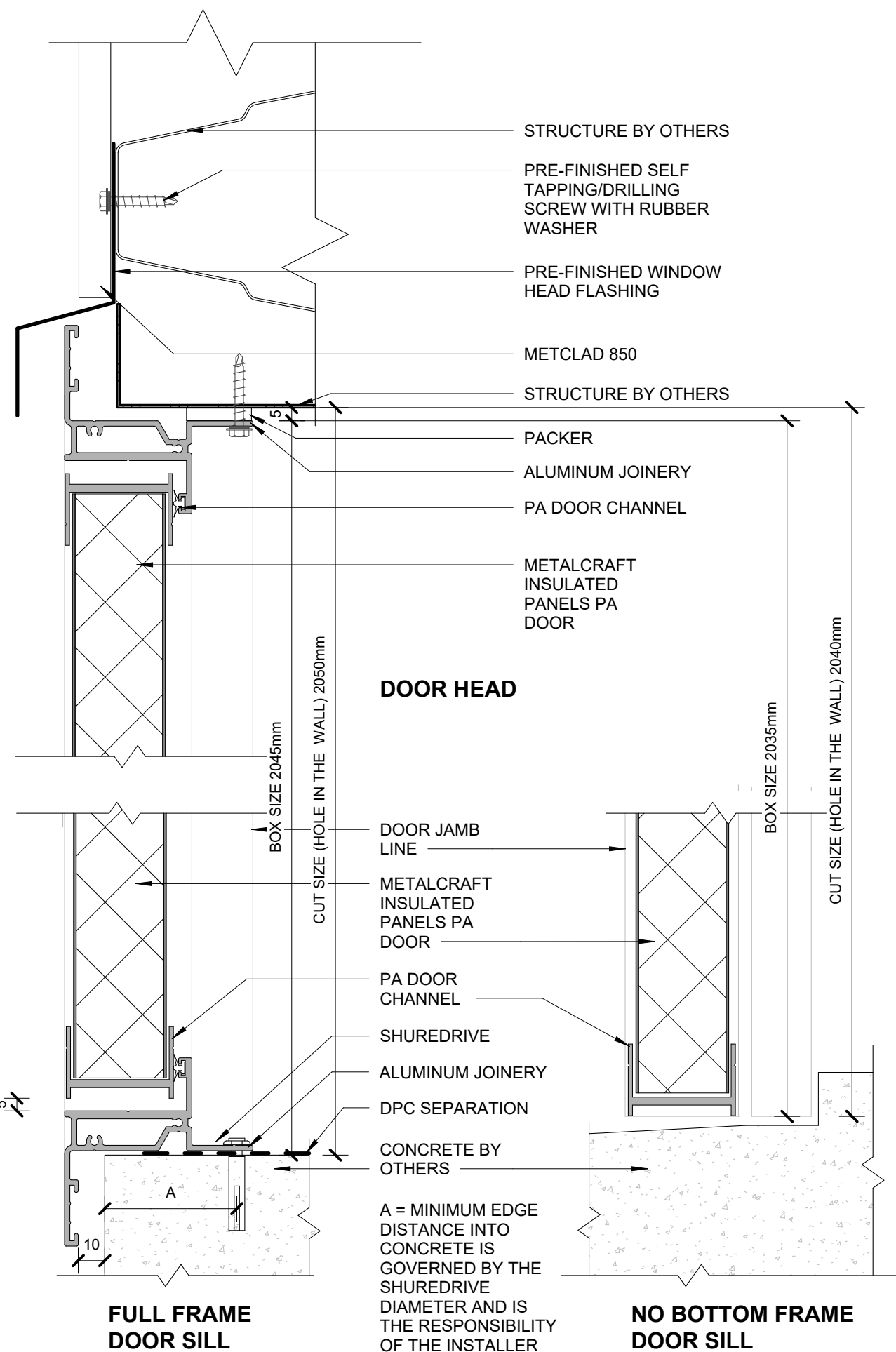
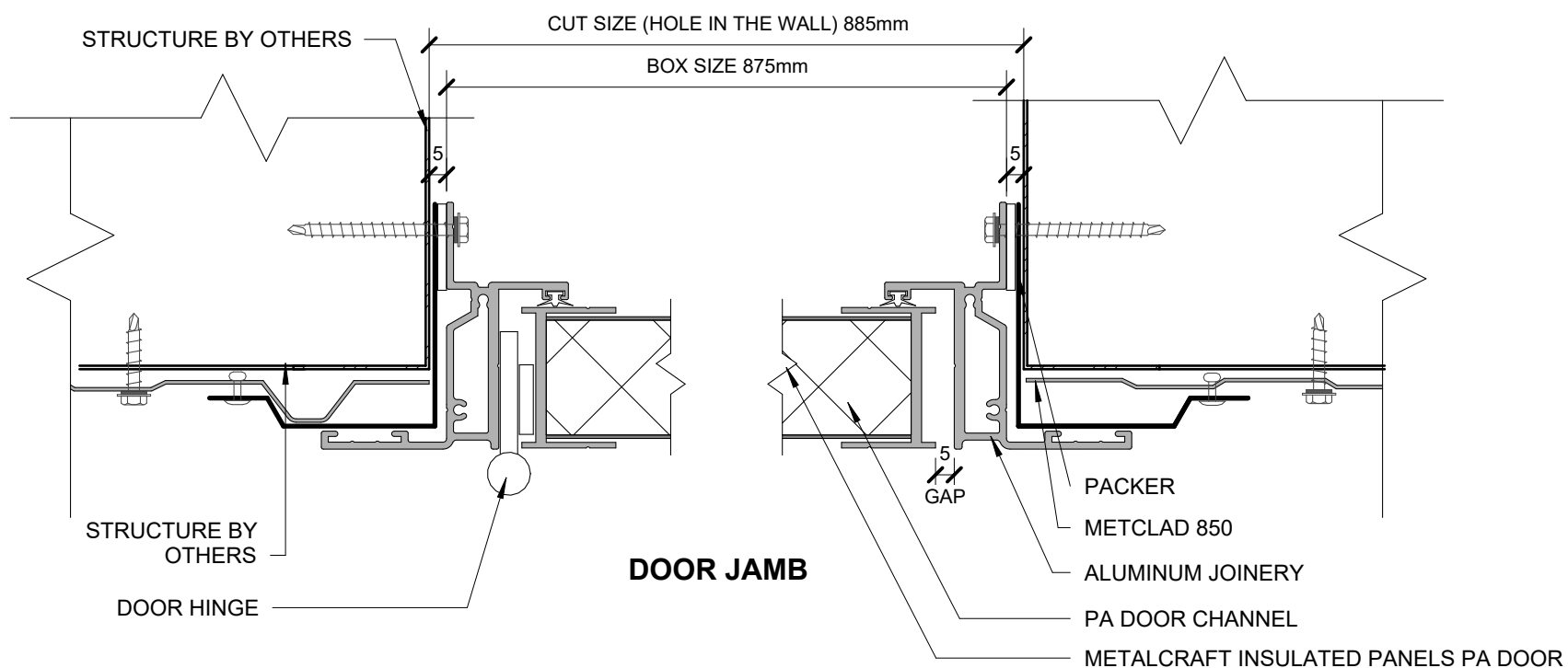

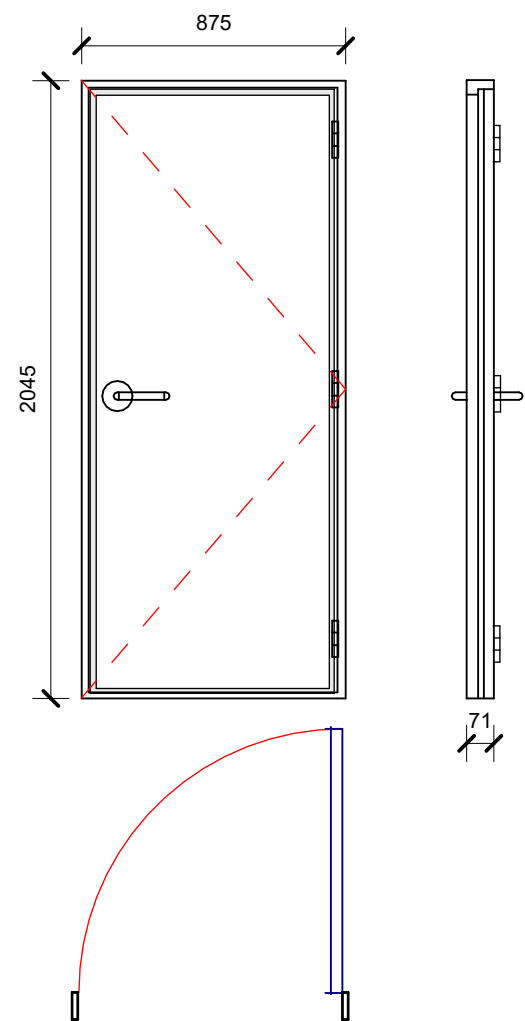

STANDARD DOOR FULL FRAME - RIGHT HAND

CUT SIZE (HOLE IN THE WALL)
HEIGHT = 2050mm
WIDTH = 885mm

BOX SIZE
HEIGHT = 2045mm
WIDTH = 875mm

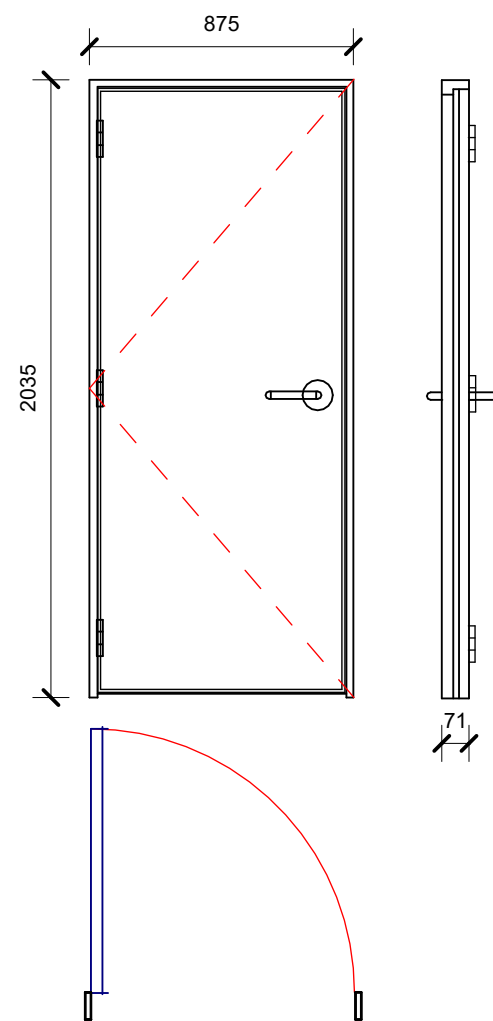

STANDARD DOOR NO BOTTOM FRAME - LEFT HAND

CUT SIZE (HOLE IN THE WALL)
HEIGHT = 2040mm
WIDTH = 885mm

BOX SIZE
HEIGHT = 2035mm
WIDTH = 875mm

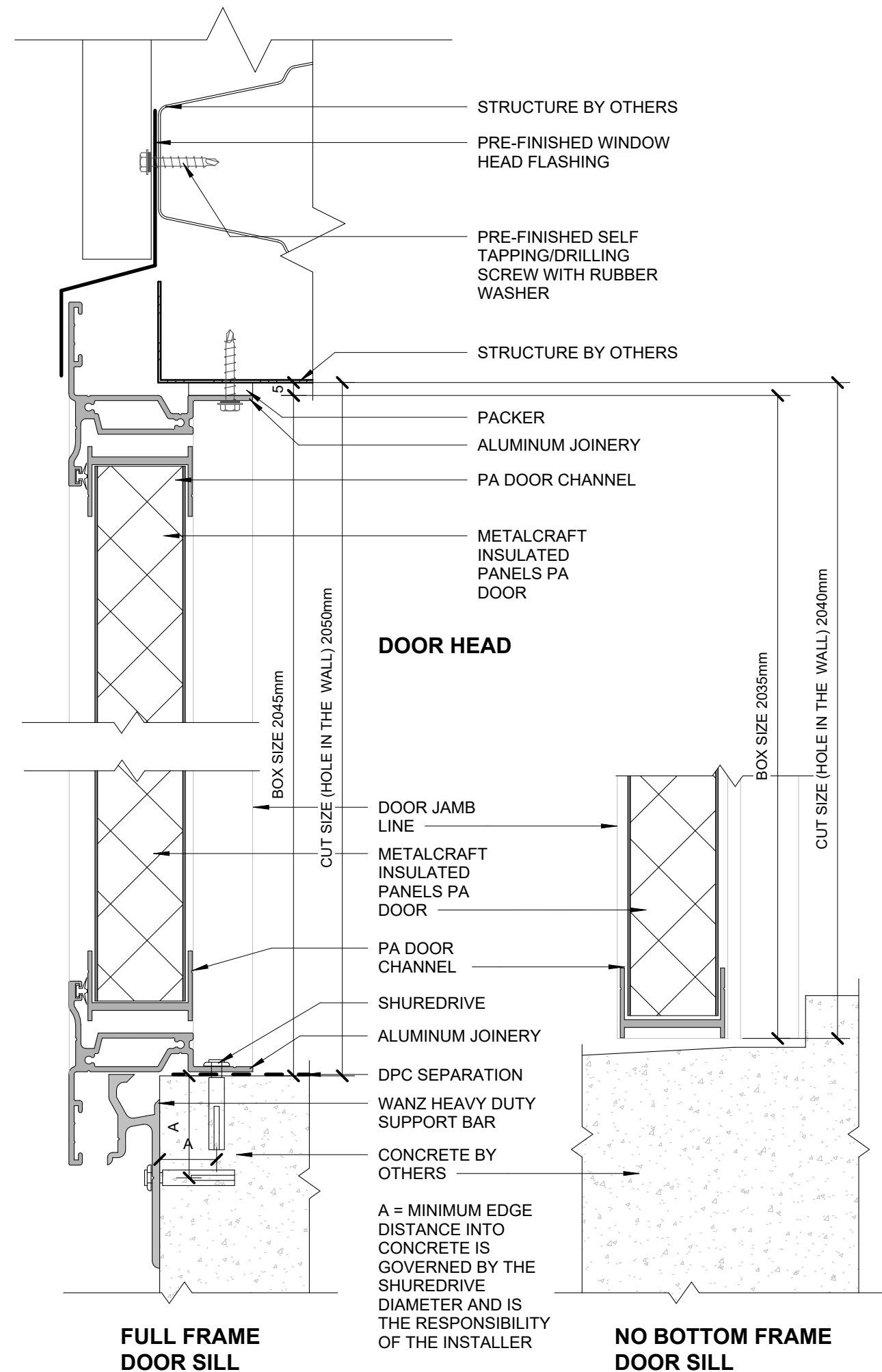
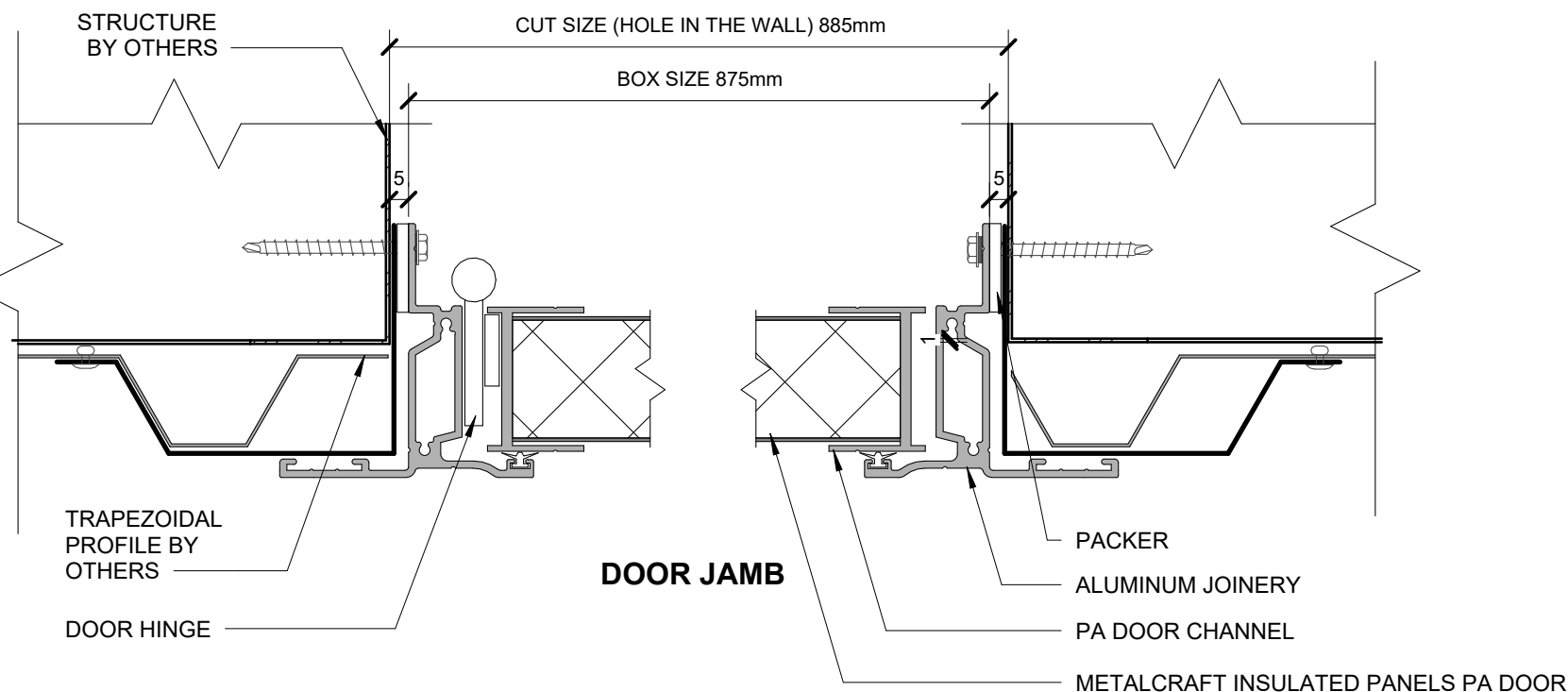

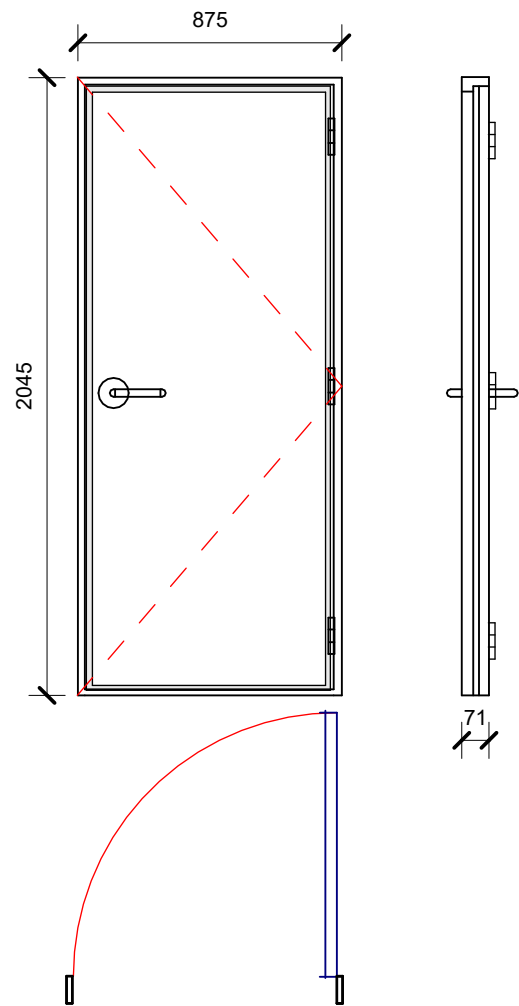

STANDARD DOOR FULL FRAME - RIGHT HAND

CUT SIZE (HOLE IN THE WALL)
HEIGHT = 2050mm
WIDTH = 885mm

BOX SIZE
HEIGHT = 2045mm
WIDTH = 875mm

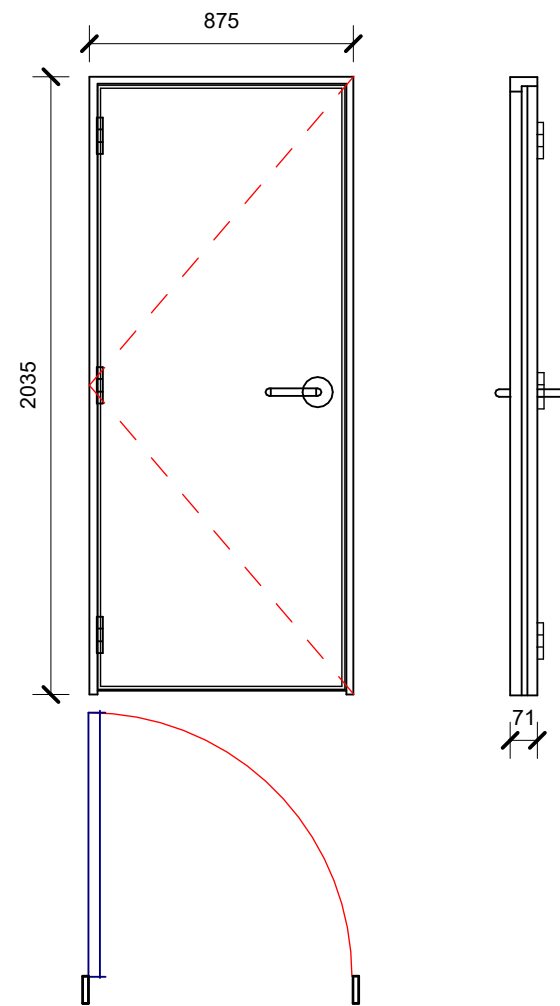

STANDARD DOOR NO BOTTOM FRAME - LEFT HAND

CUT SIZE (HOLE IN THE WALL)
HEIGHT = 2040mm
WIDTH = 885mm

BOX SIZE
HEIGHT = 2035mm
WIDTH = 875mm

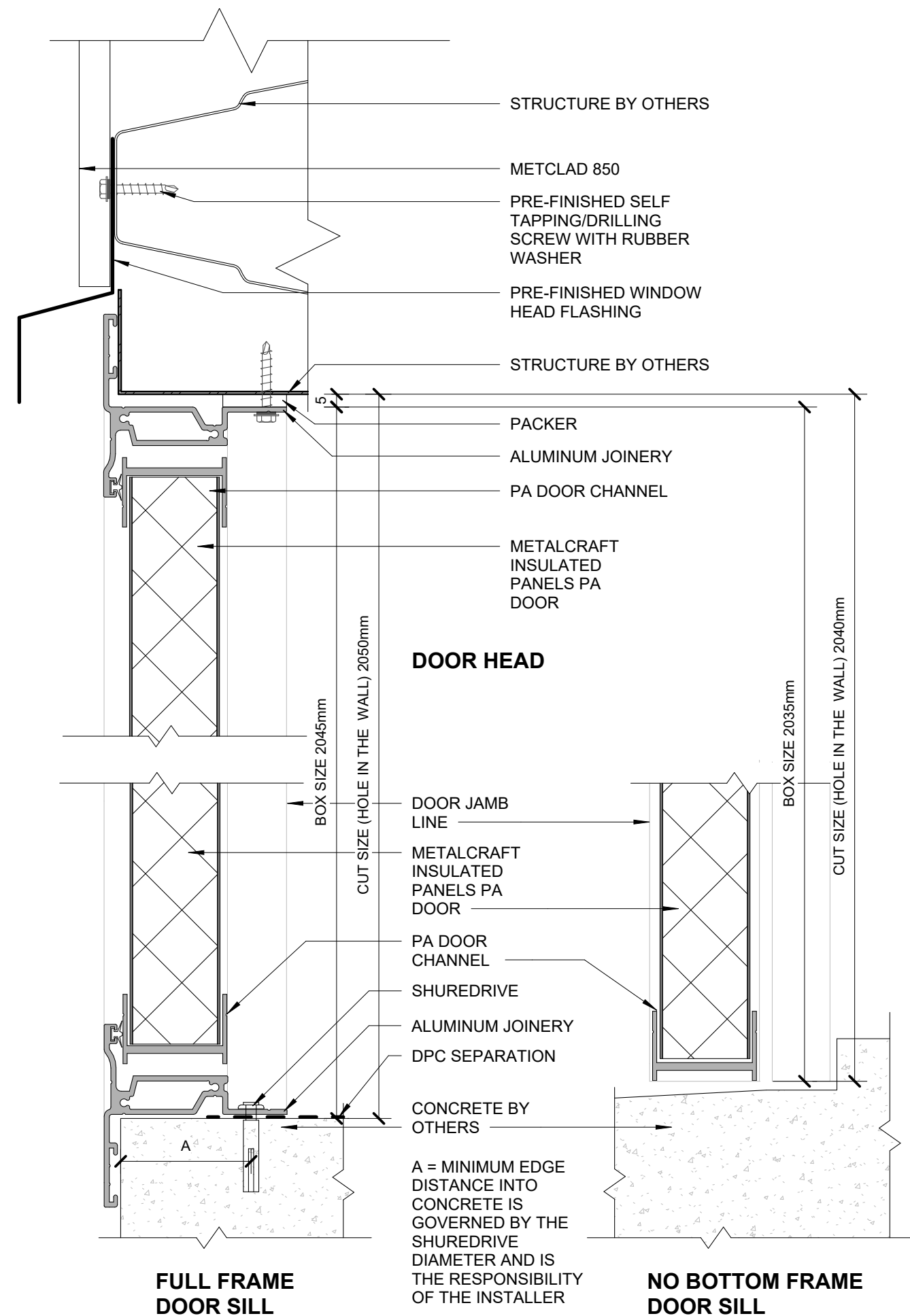
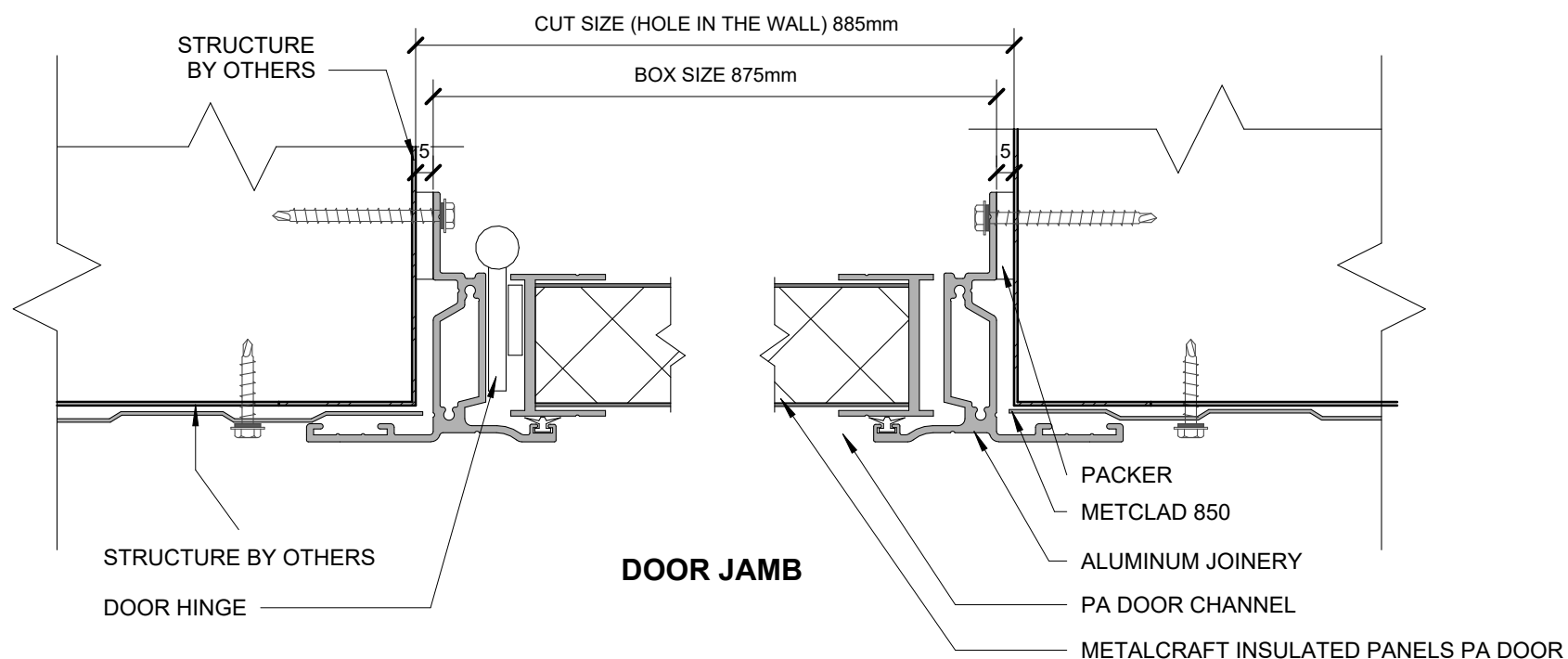

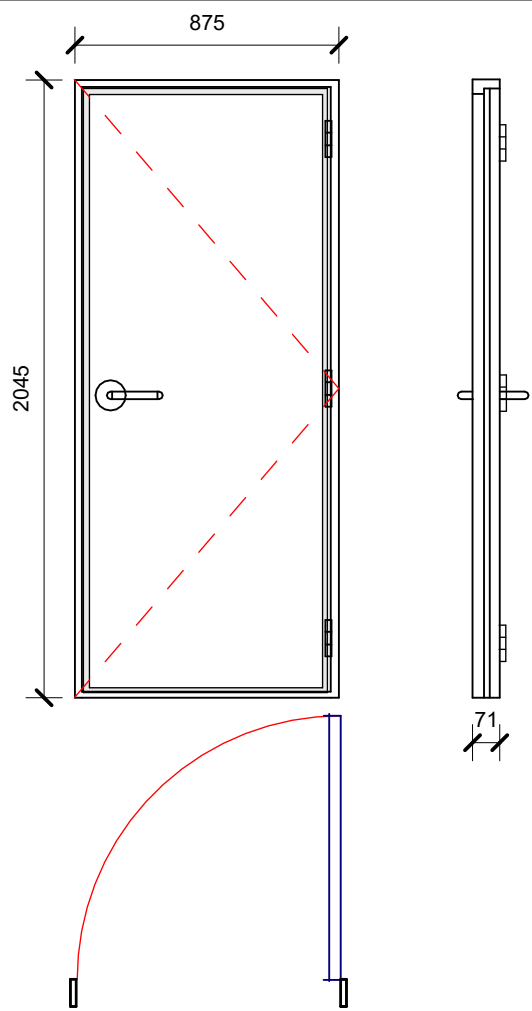

STANDARD DOOR FULL FRAME - RIGHT HAND

CUT SIZE (HOLE IN THE WALL)
HEIGHT = 2050mm
WIDTH = 885mm

BOX SIZE
HEIGHT = 2045mm
WIDTH = 875mm

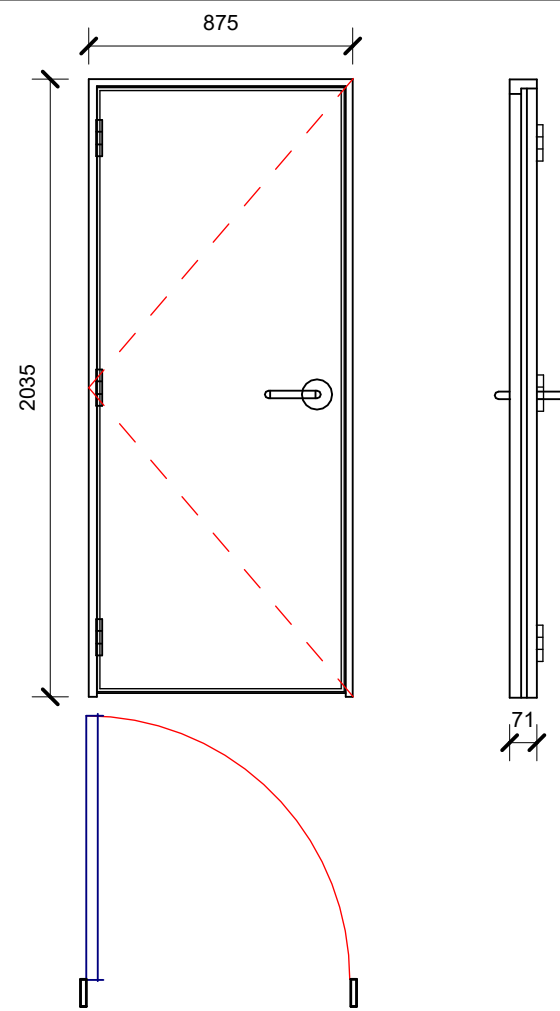

STANDARD DOOR NO BOTTOM FRAME - LEFT HAND

CUT SIZE (HOLE IN THE WALL)
HEIGHT = 2040mm
WIDTH = 885mm

BOX SIZE
HEIGHT = 2035mm
WIDTH = 875mm

