

# PA DOOR DETAIL ON METAL CLADDING

FOR SHEDS AND OUTBUILDINGS ONLY

DETAIL LIST		Revision	Date
00 / 06	COVER SHEET		
01 / 06	OUTWARDS OPENING DOOR DETAIL - TRAPEZOIDAL	1.1	JUNE 2025
02 / 06	OUTWARDS OPENING DOOR DETAIL ON METCLAD 850	1.1	JUNE 2025
03 / 06	ALTERNATIVE OUTWARDS OPENING DOOR DETAIL METCLAD 850	1.1	JUNE 2025
04 / 06	INWARDS OPENING DOOR DETAIL - TRAPEZOIDAL	1.1	JUNE 2025
05 / 06	INWARDS OPENING DOOR DETAIL ON METCLAD 850	1.1	JUNE 2025
06 / 06	ALTERNATIVE INWARDS OPENING DOOR DETAIL METCLAD 850	1.1	JUNE 2025

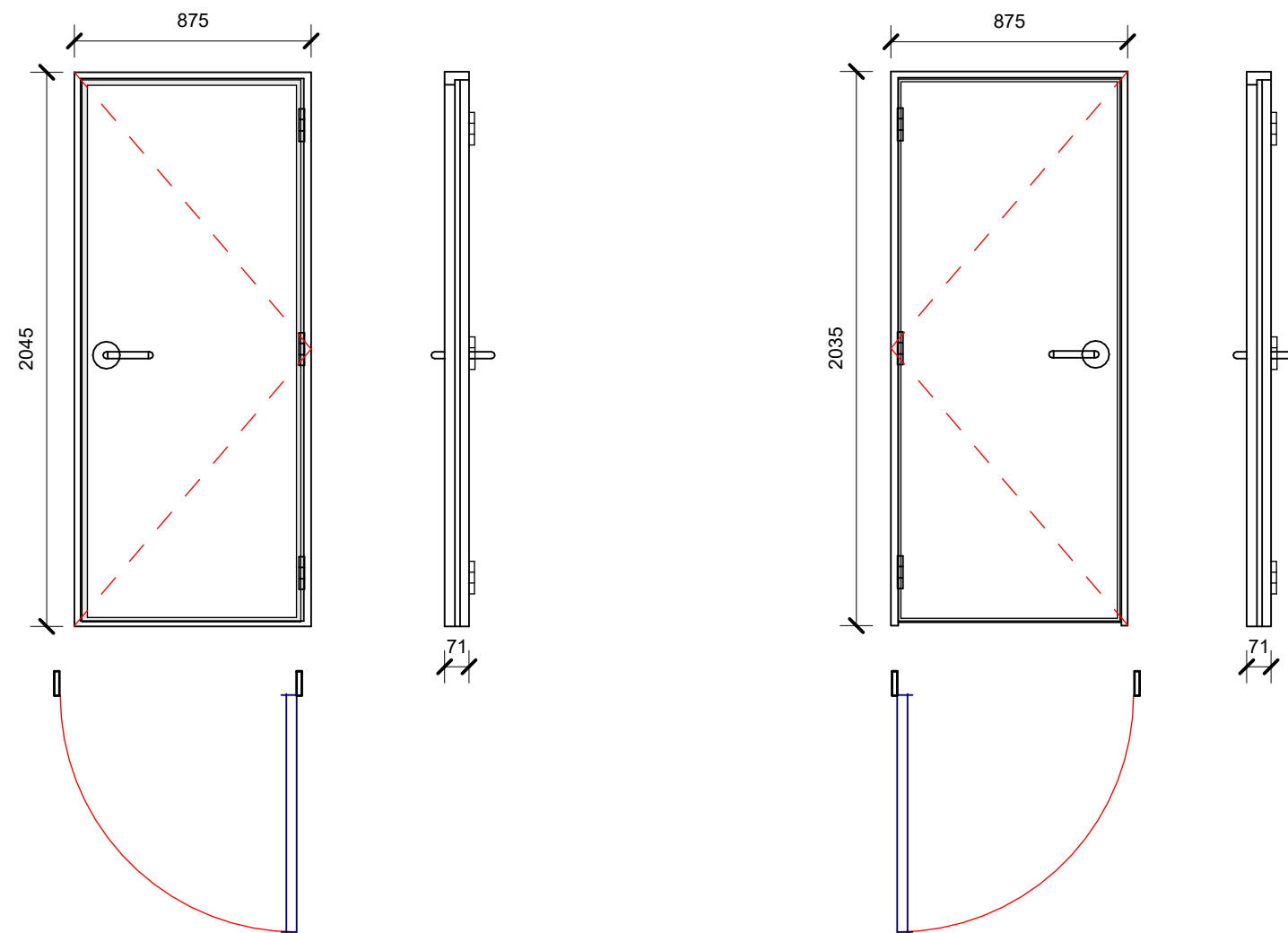

### STANDARD DOOR FULL FRAME - RIGHT HAND

**CUT SIZE (HOLE IN THE WALL)**  
HEIGHT = 2050mm  
WIDTH = 885mm

**BOX SIZE**  
HEIGHT = 2045mm  
WIDTH = 875mm

### STANDARD DOOR NO BOTTOM FRAME - LEFT HAND

**CUT SIZE (HOLE IN THE WALL)**  
HEIGHT = 2040mm  
WIDTH = 885mm

**BOX SIZE**  
HEIGHT = 2035mm  
WIDTH = 875mm

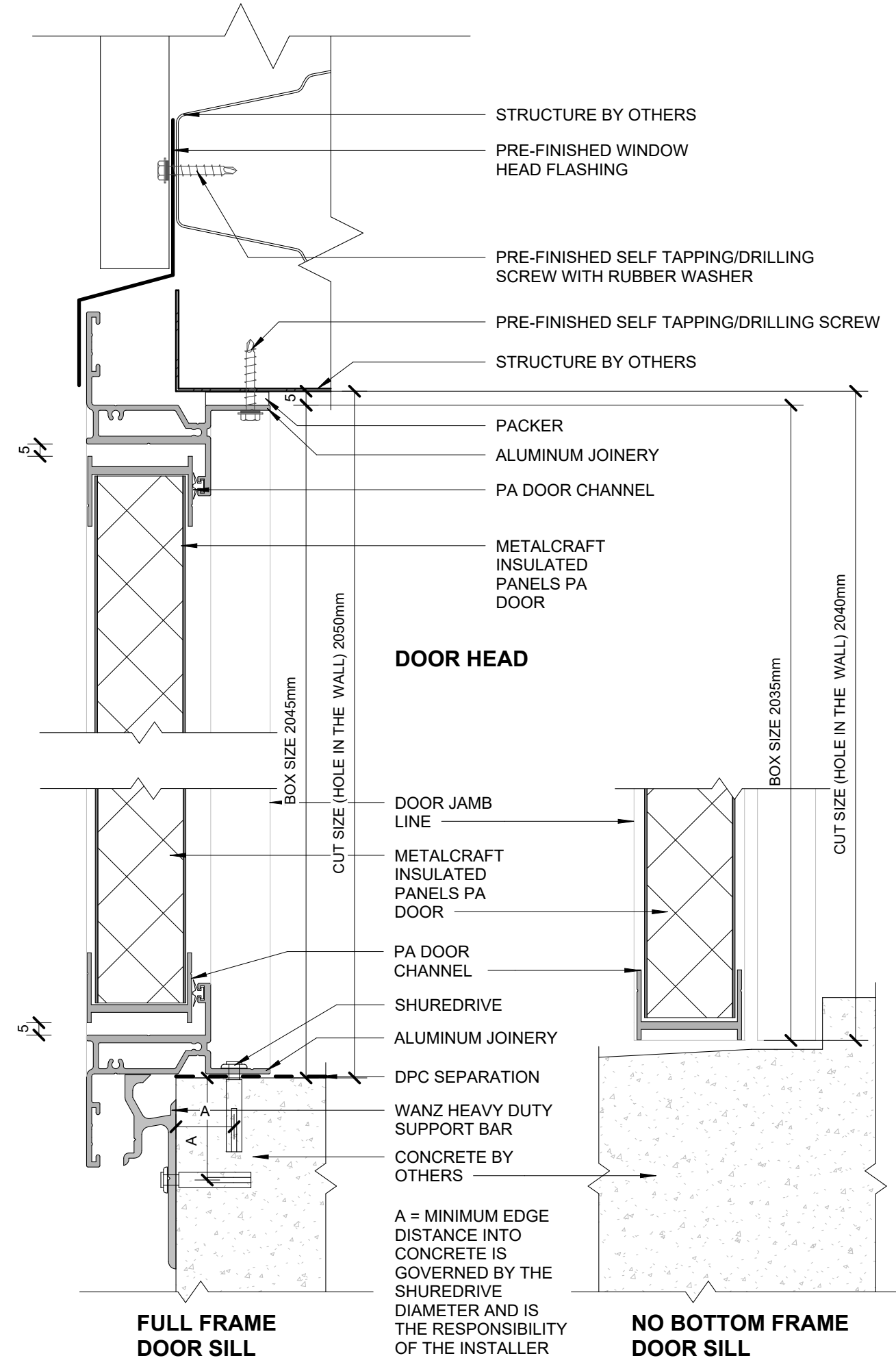
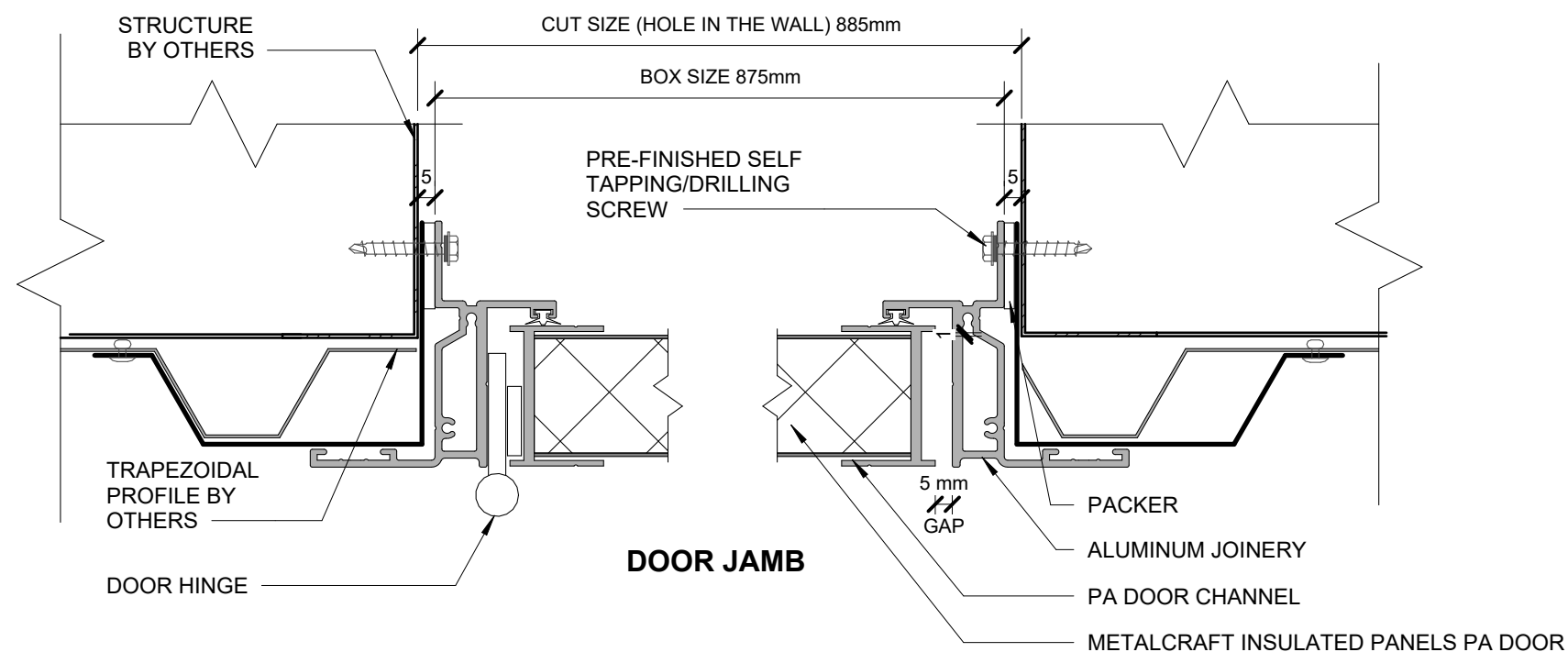

### OUTWARDS OPENING DOOR DETAIL - TRAPEZOIDAL

PA Doors

Rev. 1.1

PA DOOR DETAIL ON METAL CLADDING

Reference PADMC

Date JUNE 2025

Scale 1:25 AND 1:2

Sheet

01 / 06

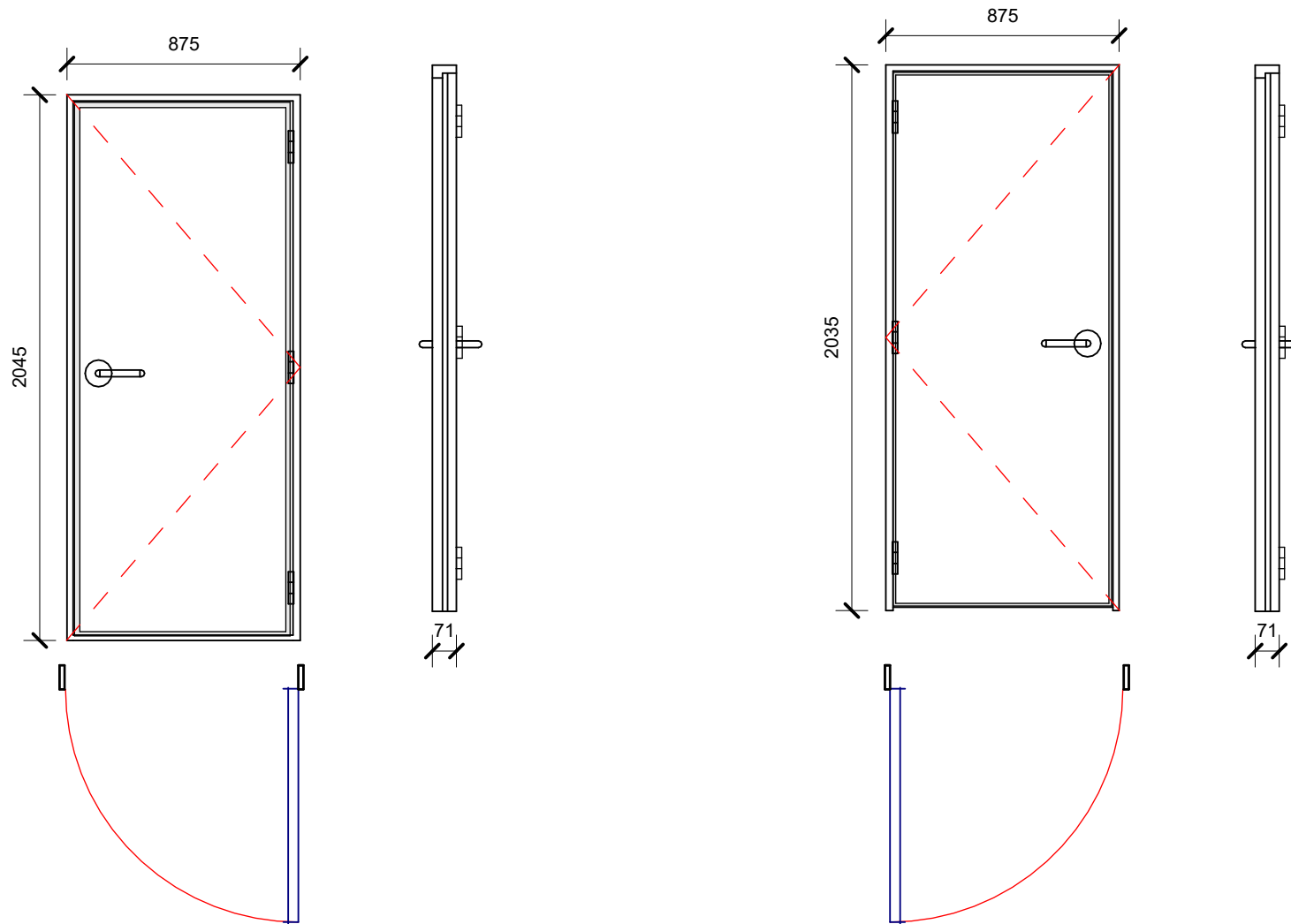

### STANDARD DOOR FULL FRAME - RIGHT HAND

**CUT SIZE (HOLE IN THE WALL)**  
HEIGHT = 2050mm  
WIDTH = 885mm

**BOX SIZE**  
HEIGHT = 2045mm  
WIDTH = 875mm

### STANDARD DOOR NO BOTTOM FRAME - LEFT HAND

**CUT SIZE (HOLE IN THE WALL)**  
HEIGHT = 2040mm  
WIDTH = 885mm

**BOX SIZE**  
HEIGHT = 2035mm  
WIDTH = 875mm

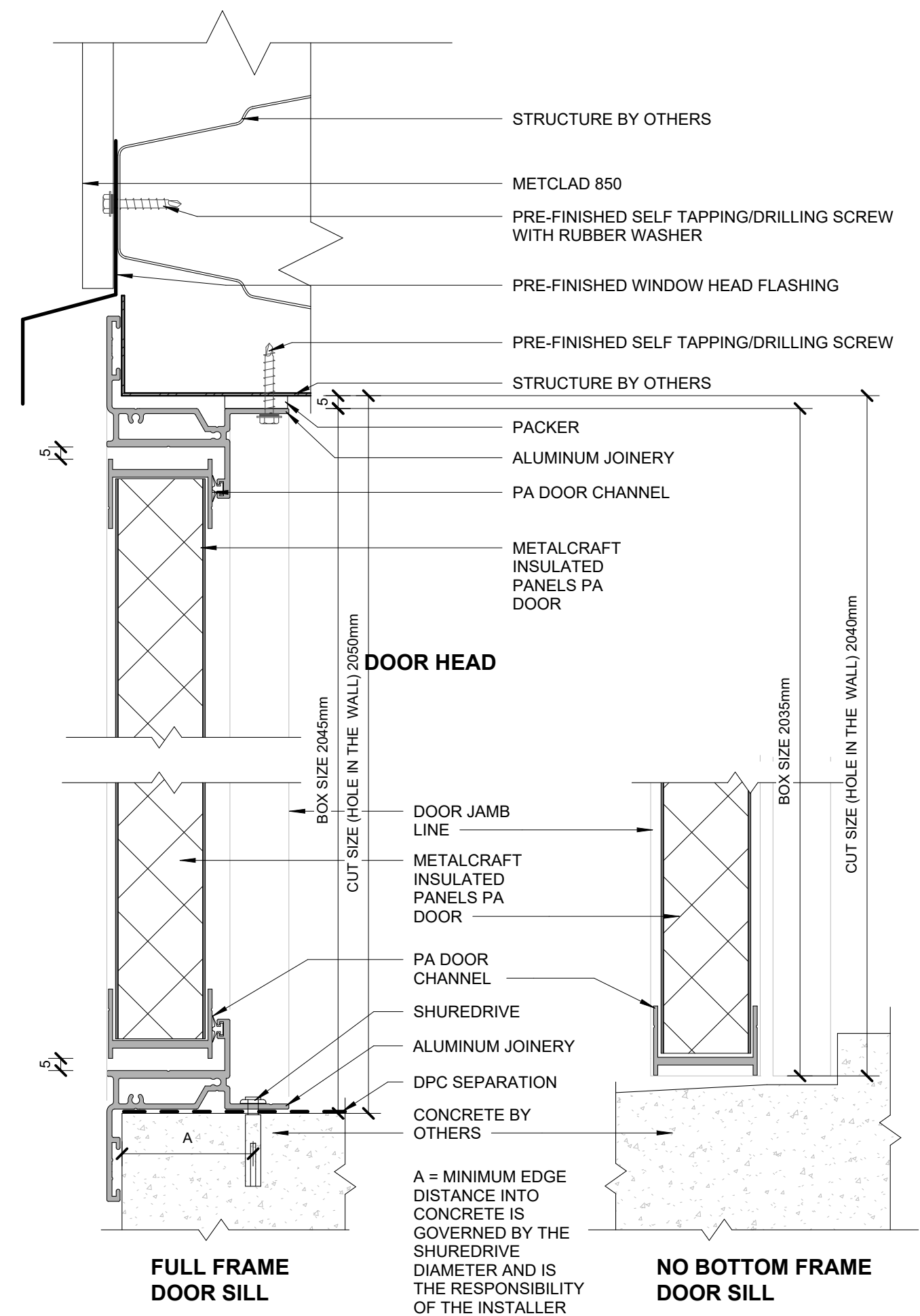
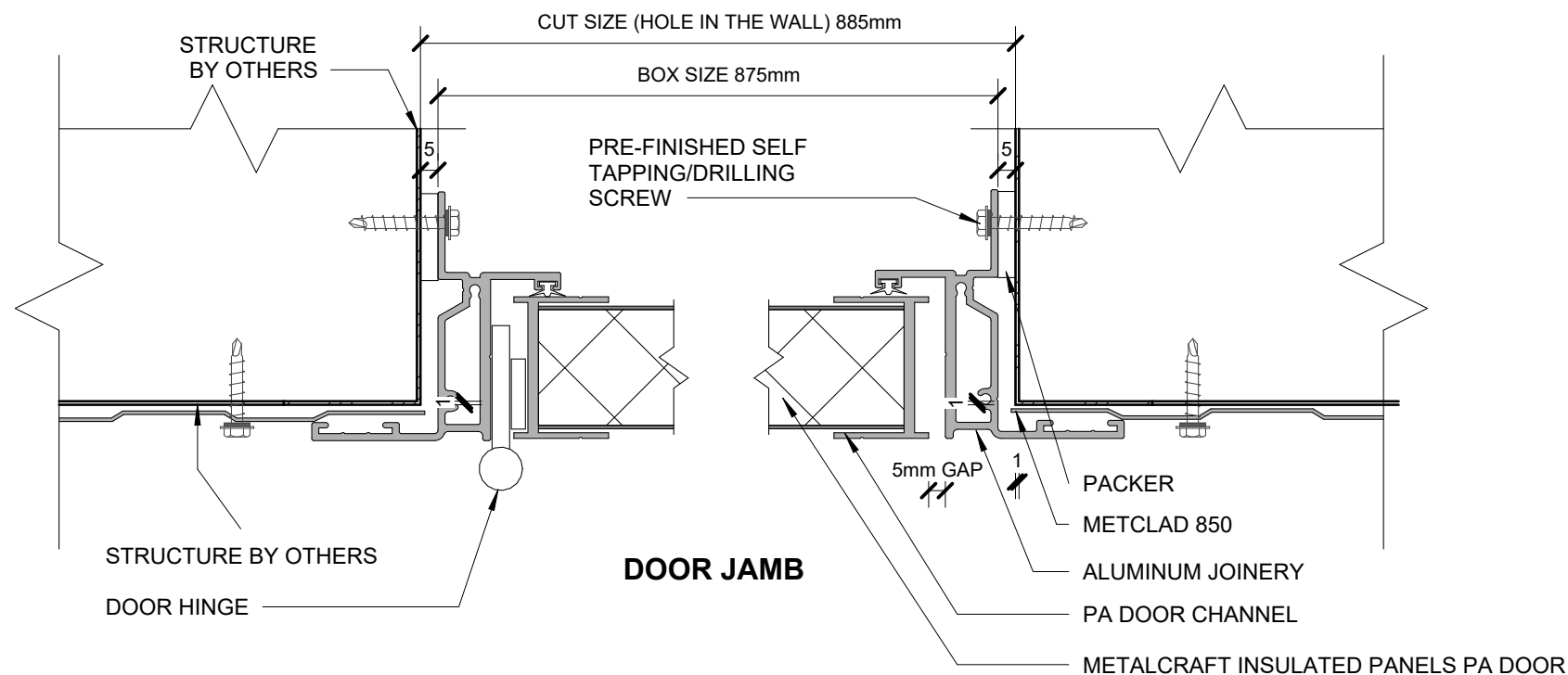

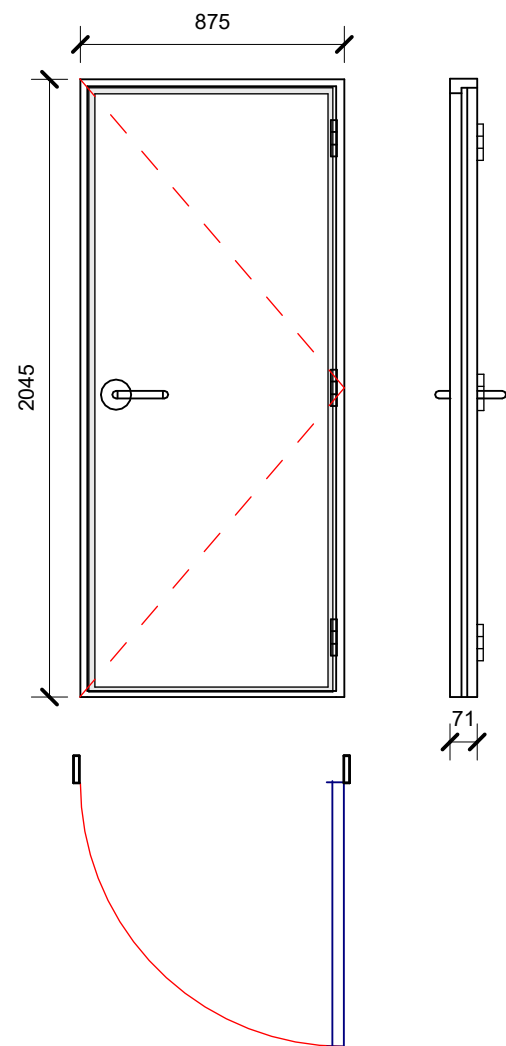

### STANDARD DOOR FULL FRAME - RIGHT HAND

**CUT SIZE (HOLE IN THE WALL)**  
HEIGHT = 2050mm  
WIDTH = 885mm

**BOX SIZE**  
HEIGHT = 2045mm  
WIDTH = 875mm

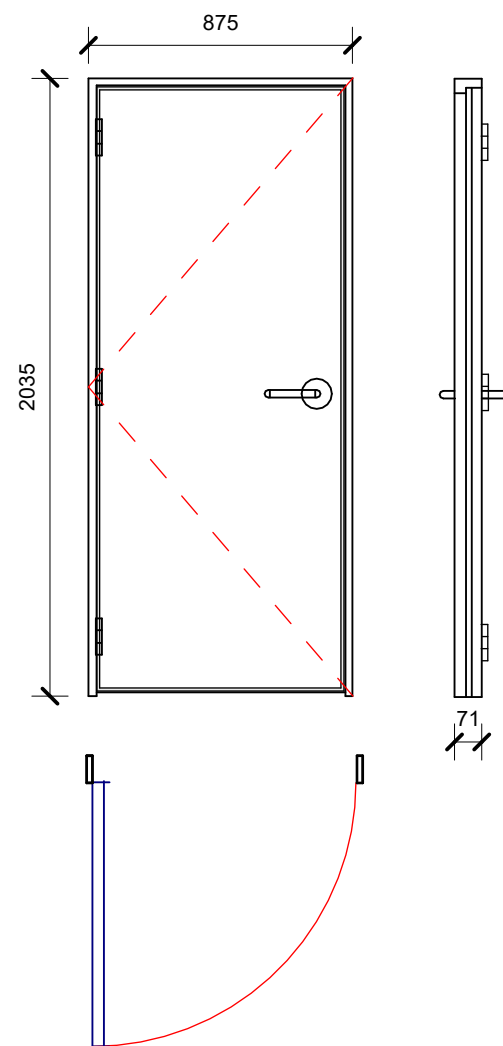

### STANDARD DOOR NO BOTTOM FRAME - LEFT HAND

**CUT SIZE (HOLE IN THE WALL)**  
HEIGHT = 2040mm  
WIDTH = 885mm

**BOX SIZE**  
HEIGHT = 2035mm  
WIDTH = 875mm

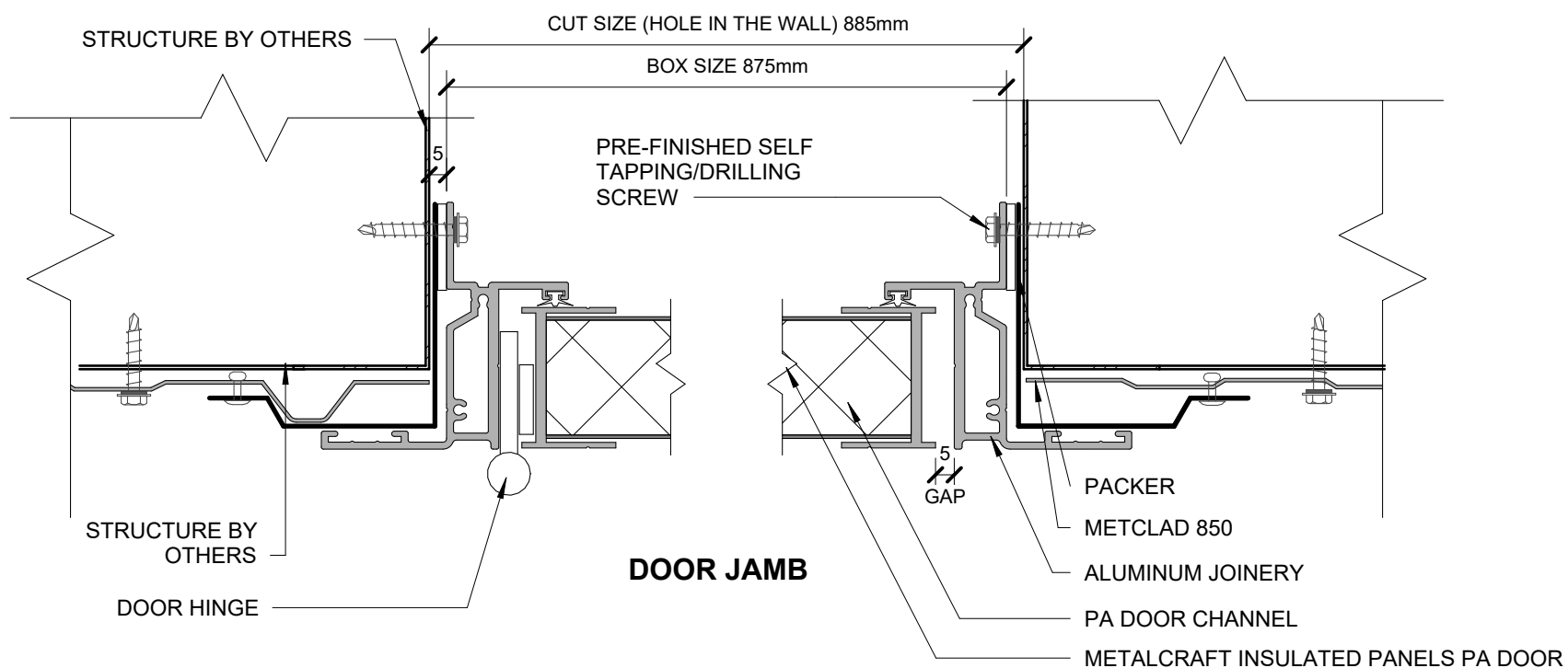

### DOOR JAMB

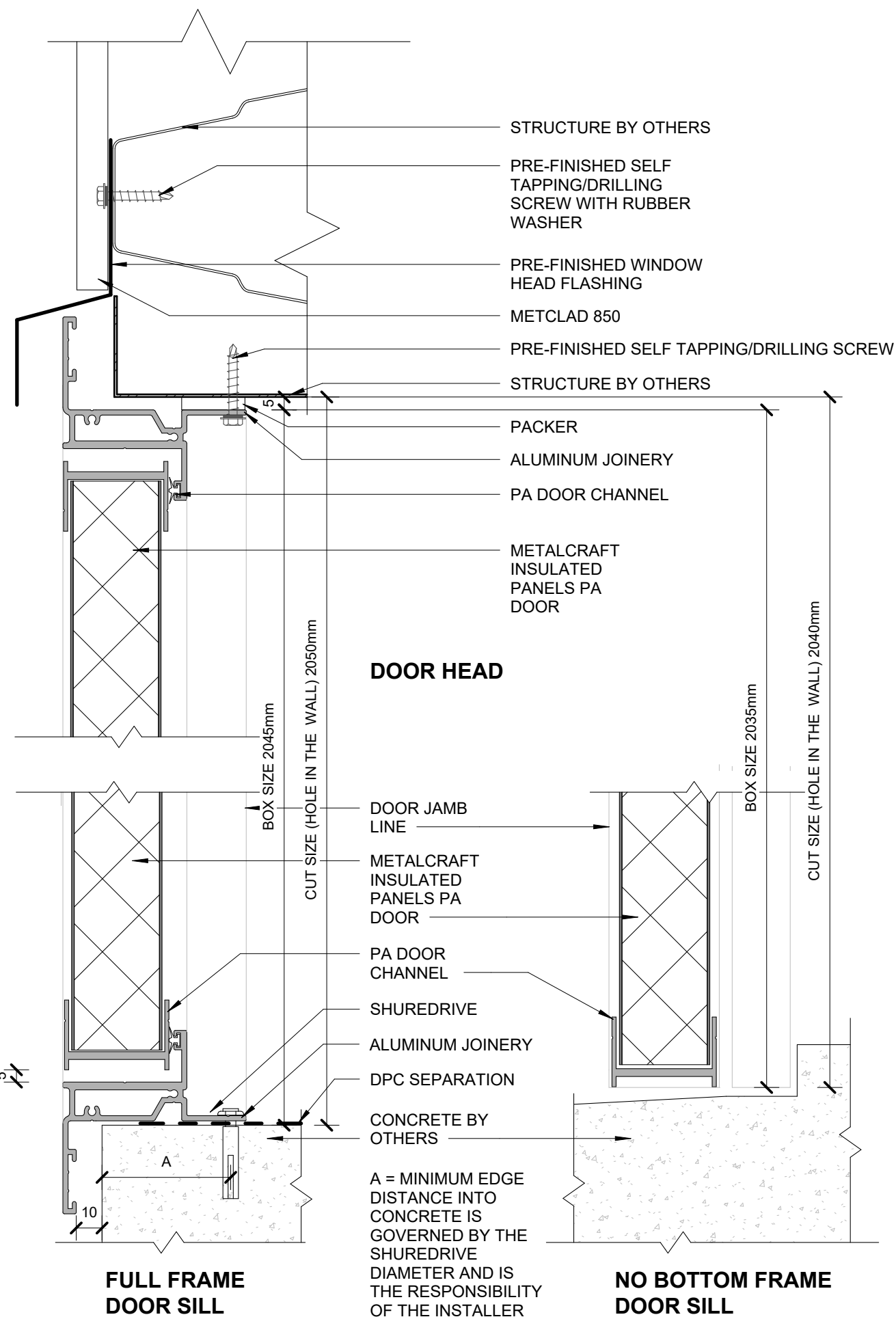

### FULL FRAME DOOR SILL

### NO BOTTOM FRAME DOOR SILL

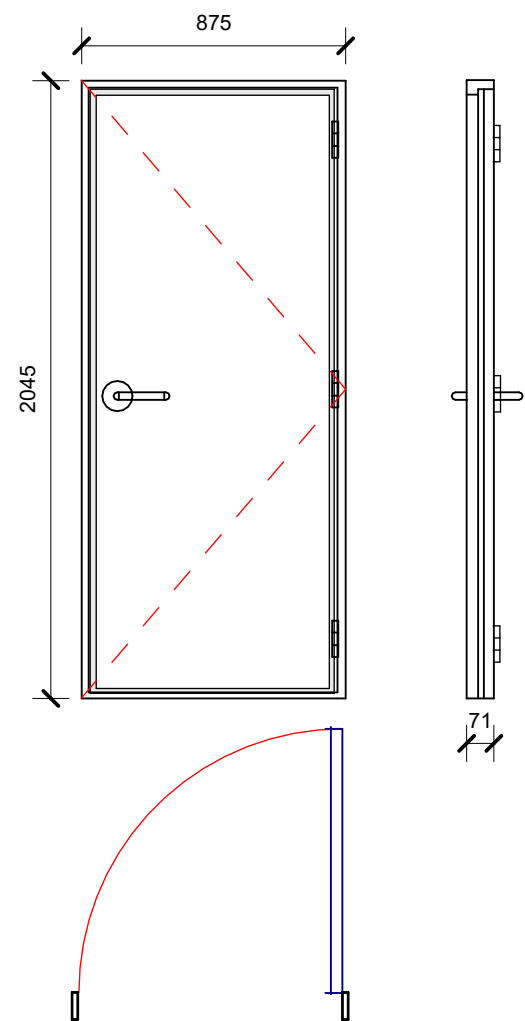

### STANDARD DOOR FULL FRAME - RIGHT HAND

**CUT SIZE (HOLE IN THE WALL)**  
HEIGHT = 2050mm  
WIDTH = 885mm

**BOX SIZE**  
HEIGHT = 2045mm  
WIDTH = 875mm

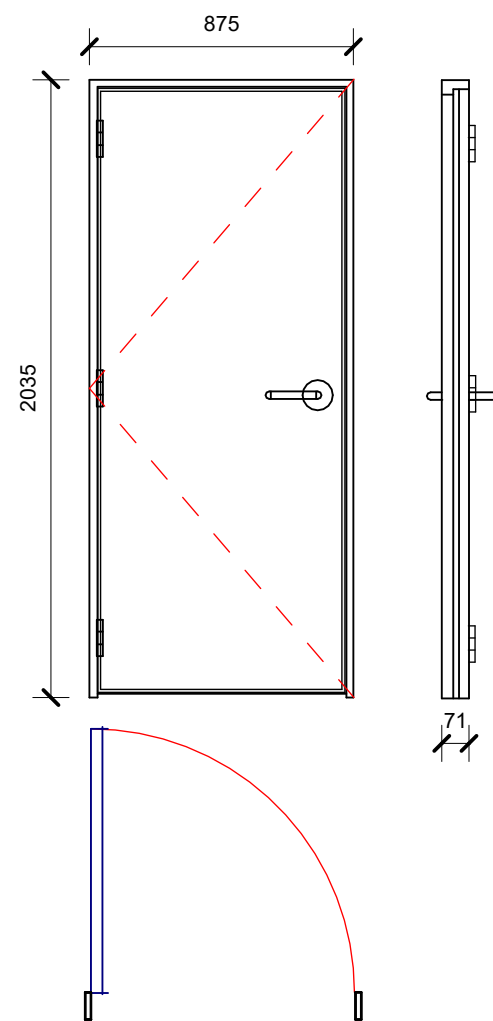

### STANDARD DOOR NO BOTTOM FRAME - LEFT HAND

**CUT SIZE (HOLE IN THE WALL)**  
HEIGHT = 2040mm  
WIDTH = 885mm

**BOX SIZE**  
HEIGHT = 2035mm  
WIDTH = 875mm

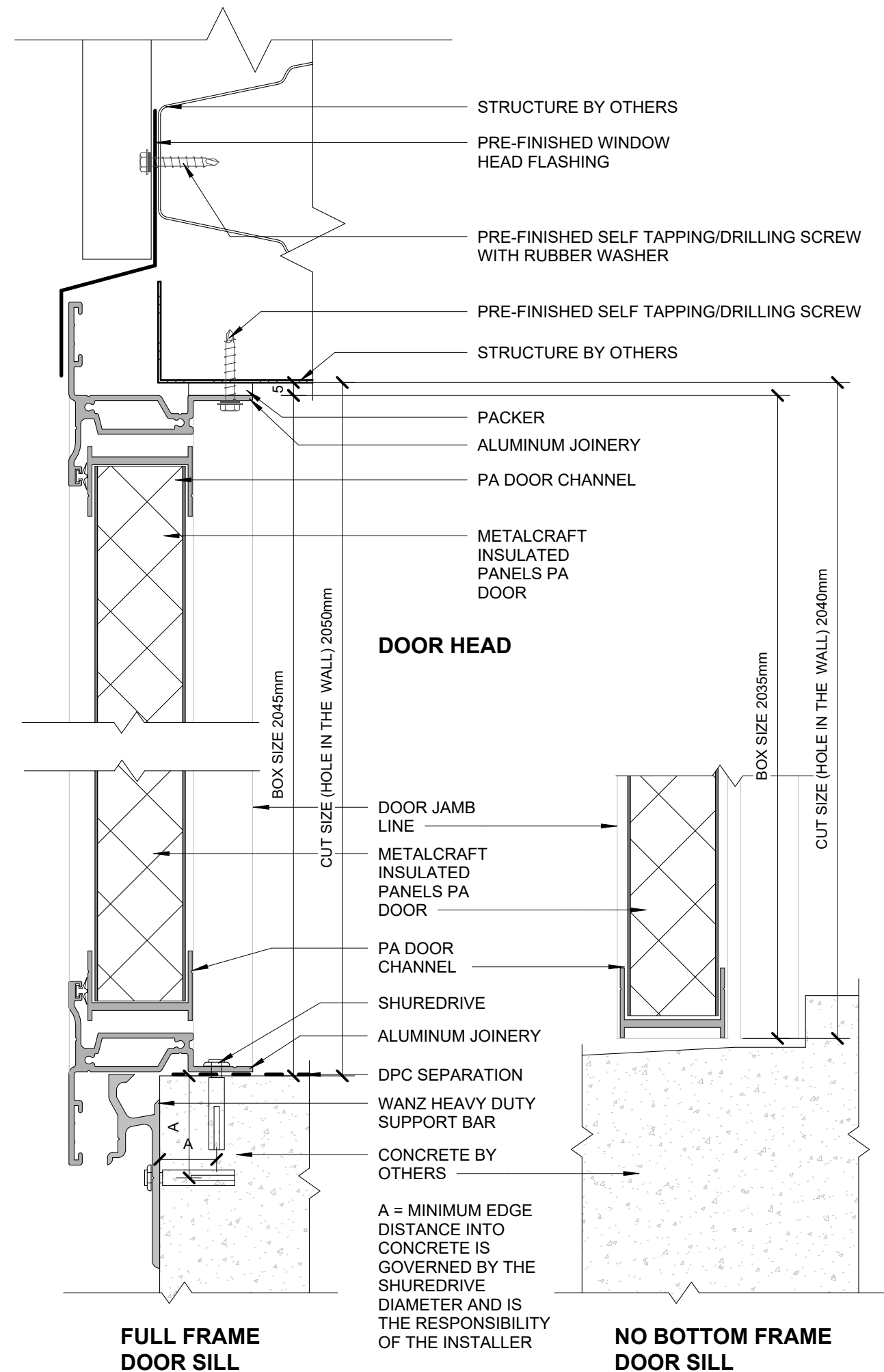
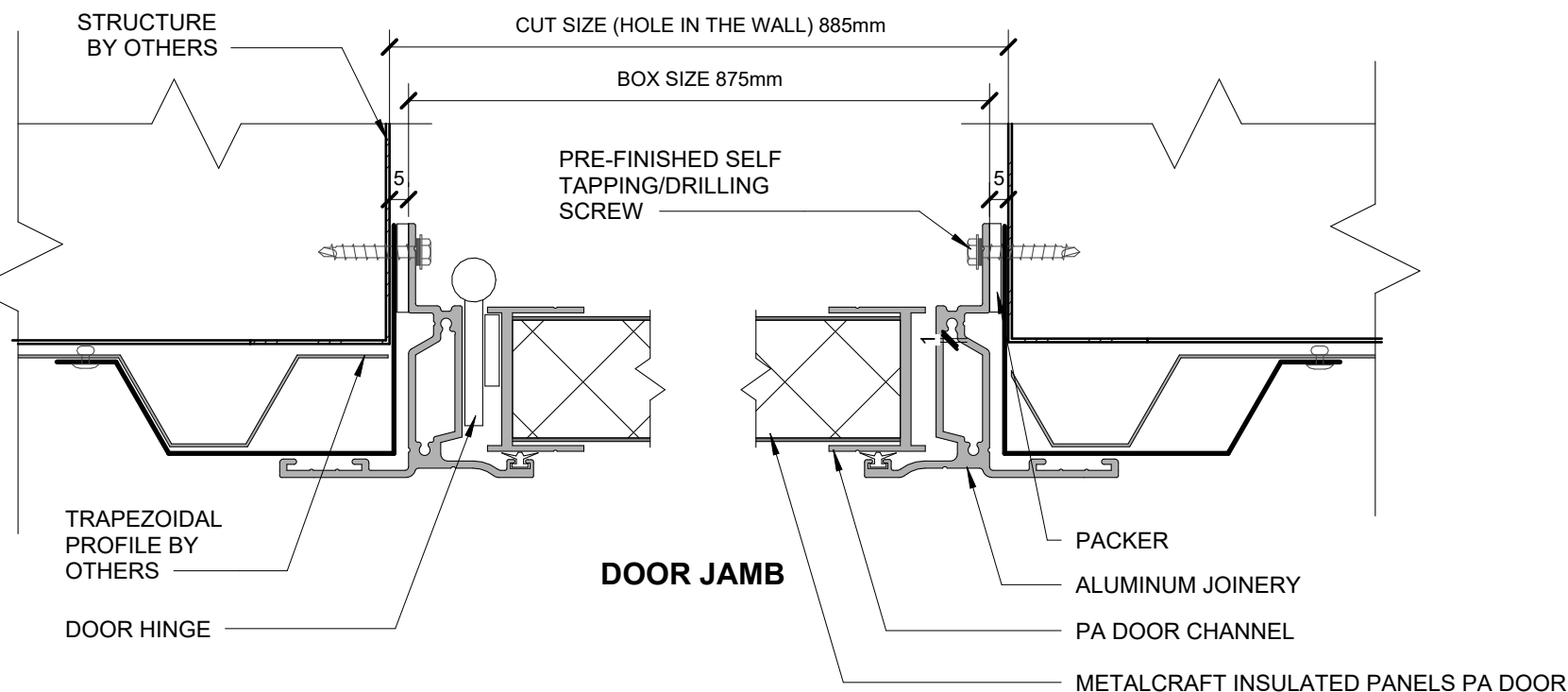

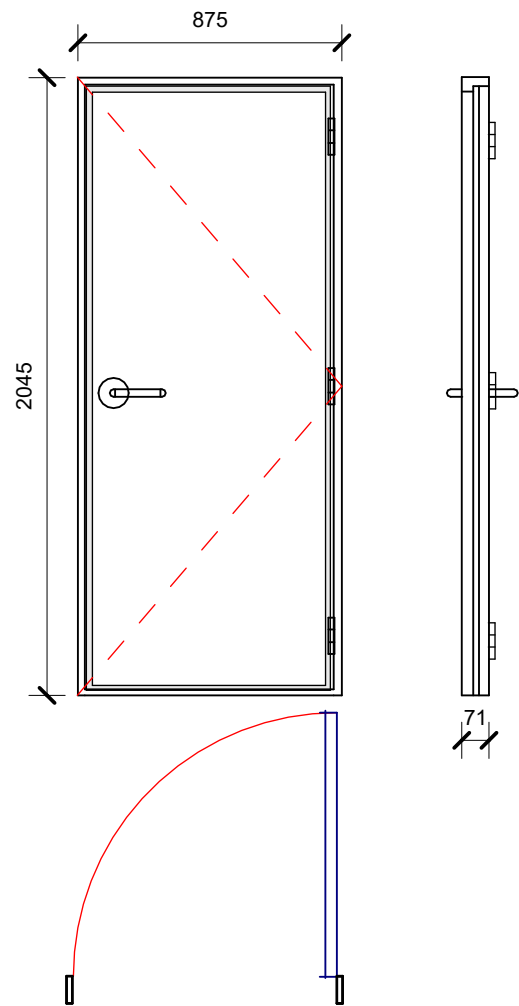

### STANDARD DOOR FULL FRAME - RIGHT HAND

**CUT SIZE (HOLE IN THE WALL)**  
HEIGHT = 2050mm  
WIDTH = 885mm

**BOX SIZE**  
HEIGHT = 2045mm  
WIDTH = 875mm

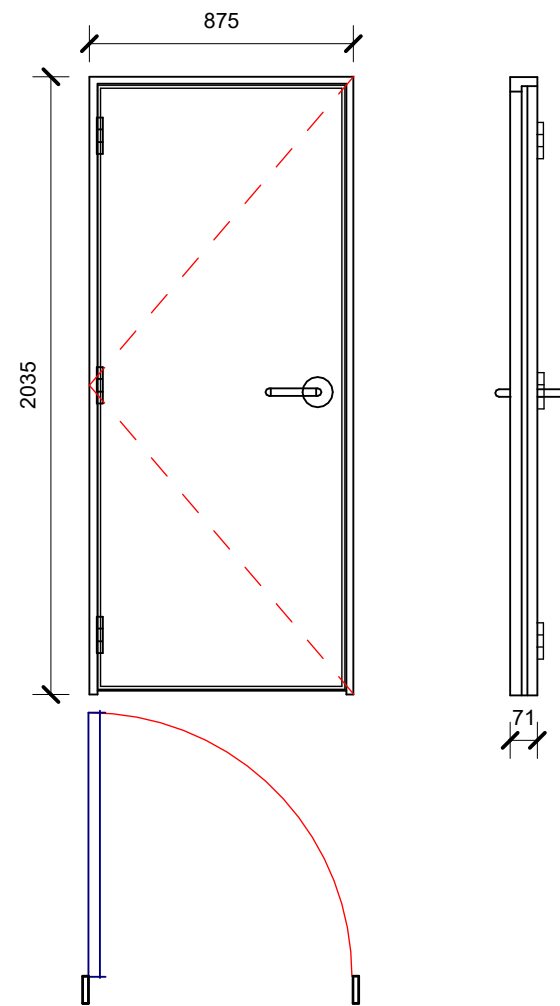

### STANDARD DOOR NO BOTTOM FRAME - LEFT HAND

**CUT SIZE (HOLE IN THE WALL)**  
HEIGHT = 2040mm  
WIDTH = 885mm

**BOX SIZE**  
HEIGHT = 2035mm  
WIDTH = 875mm

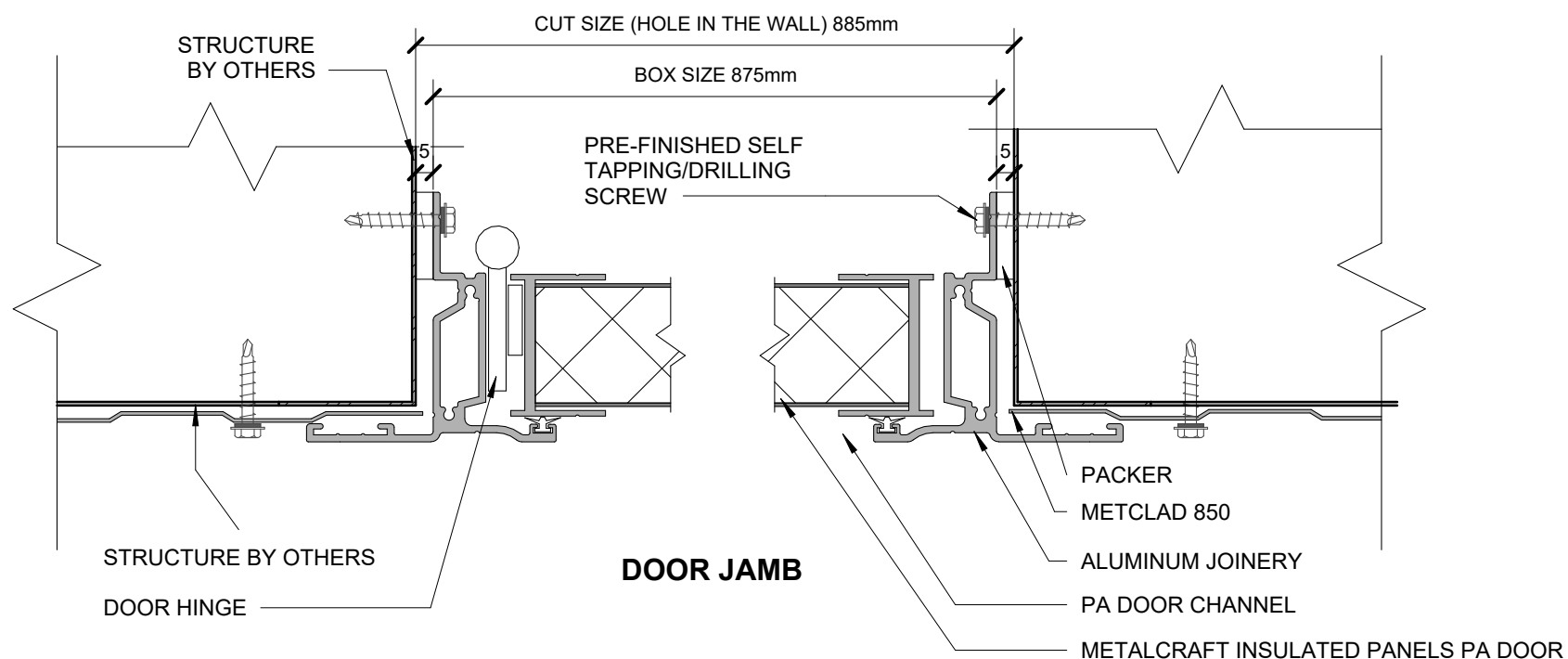

### DOOR JAMB

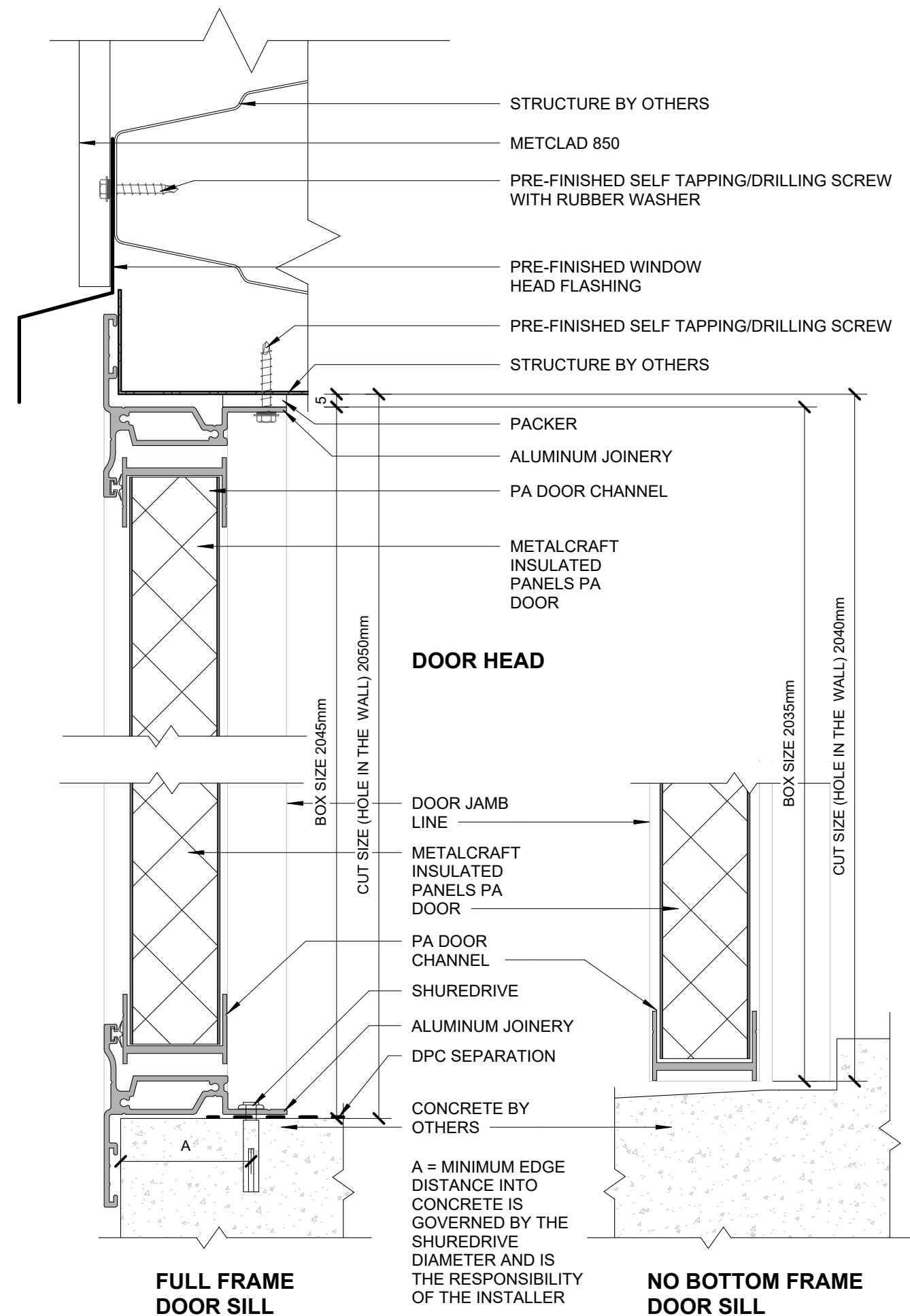

### DOOR HEAD

### FULL FRAME DOOR SILL

### NO BOTTOM FRAME DOOR SILL



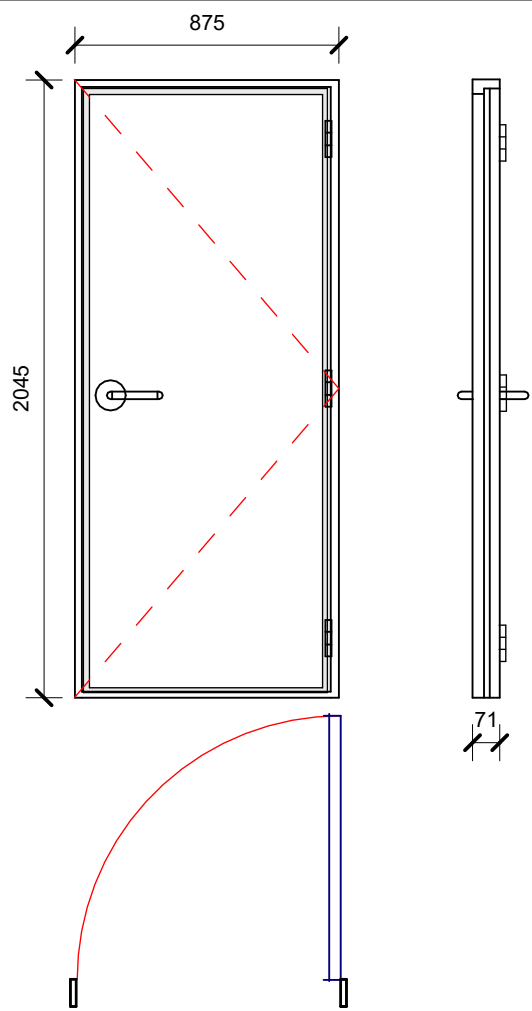

**STANDARD DOOR  
FULL FRAME - RIGHT HAND**

**CUT SIZE (HOLE IN THE WALL)**  
HEIGHT = 2050mm  
WIDTH = 885mm

**BOX SIZE**  
HEIGHT = 2045mm  
WIDTH = 875mm

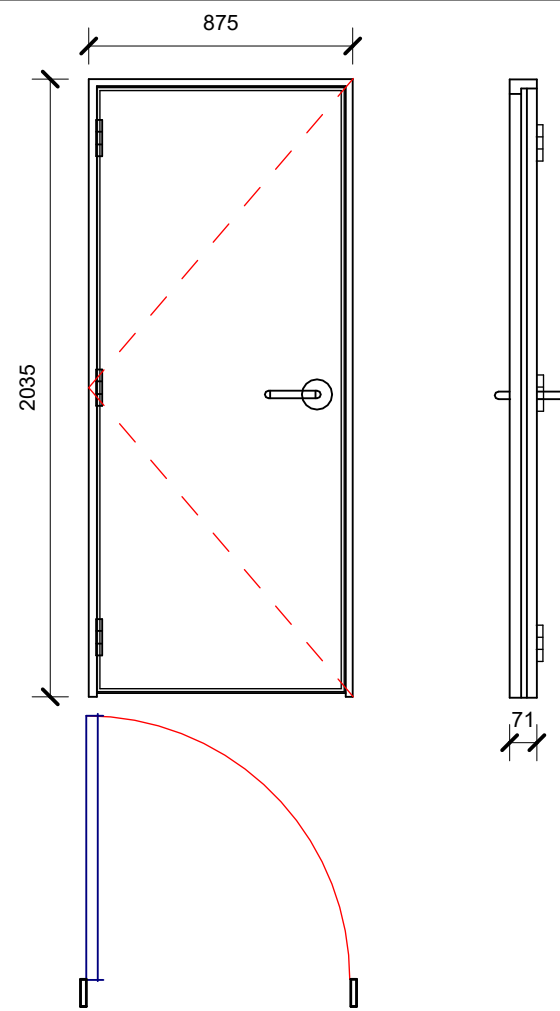

**STANDARD DOOR  
NO BOTTOM FRAME - LEFT HAND**

**CUT SIZE (HOLE IN THE WALL)**  
HEIGHT = 2040mm  
WIDTH = 885mm

**BOX SIZE**  
HEIGHT = 2035mm  
WIDTH = 875mm

