

PA DOUBLE DOOR DETAIL ON INSULATED PANEL

FOR SHEDS AND OUTBUILDINGS ONLY

DETAIL LIST		Revision	Date
00 / 04	COVER SHEET		
01 / 04	OUTWARDS OPENING DOOR DETAIL - INSULATED FLAT PANEL	1.1	JUNE 2025
02 / 04	OUTWARDS OPENING DOOR DETAIL - INSULATED TRAPEZOIDAL PANEL	1.1	JUNE 2025
03 / 04	INWARDS OPENING DOOR DETAIL - INSULATED FLAT PANEL	1.1	JUNE 2025
04 / 04	INWARDS OPENING DOOR DETAIL - INSULATED TRAPEZOIDAL PANEL	1.1	JUNE 2025

THESE DETAILS HAVE CURRENTLY NOT BEEN REVIEWED OR APPROVED UNDER THE CODEMARK CERTIFICATE. OUR AIM IS TO OBTAIN APPROVAL FOR THESE DETAILS AT A FUTURE DATE. PLEASE CONSULT METALCRAFT INSULATED PANELS.

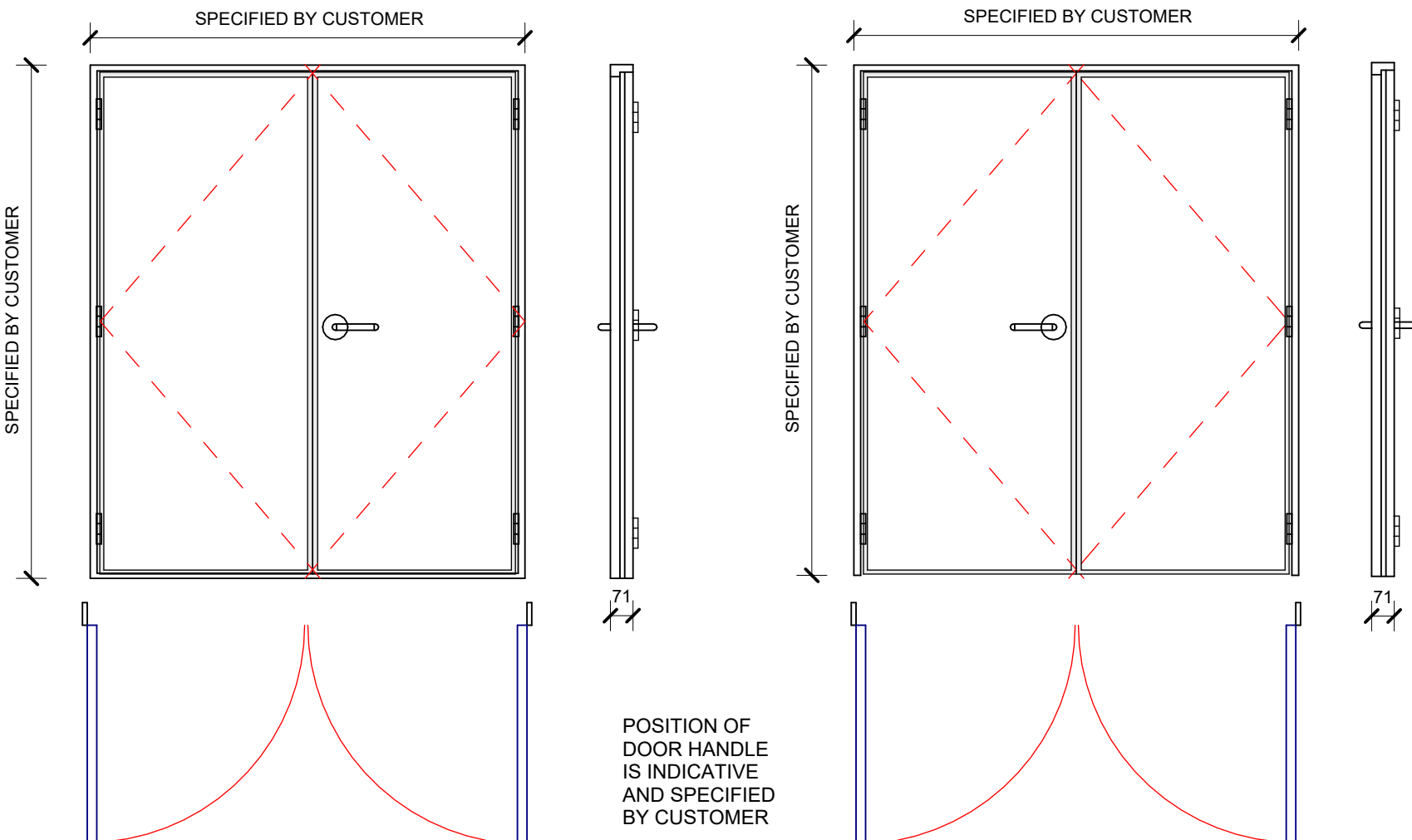

**STANDARD DOOR
FULL FRAME - RIGHT HAND**

CUT SIZE (HOLE IN THE WALL)
HEIGHT = Specified By Customer
WIDTH = Specified By Customer

BOX SIZE
HEIGHT = Specified By Customer
WIDTH = Specified By Customer

**STANDARD DOOR
NO BOTTOM FRAME - LEFT HAND**

CUT SIZE (HOLE IN THE WALL)
HEIGHT = Specified By Customer
WIDTH = Specified By Customer

BOX SIZE
HEIGHT = Specified By Customer
WIDTH = Specified By Customer

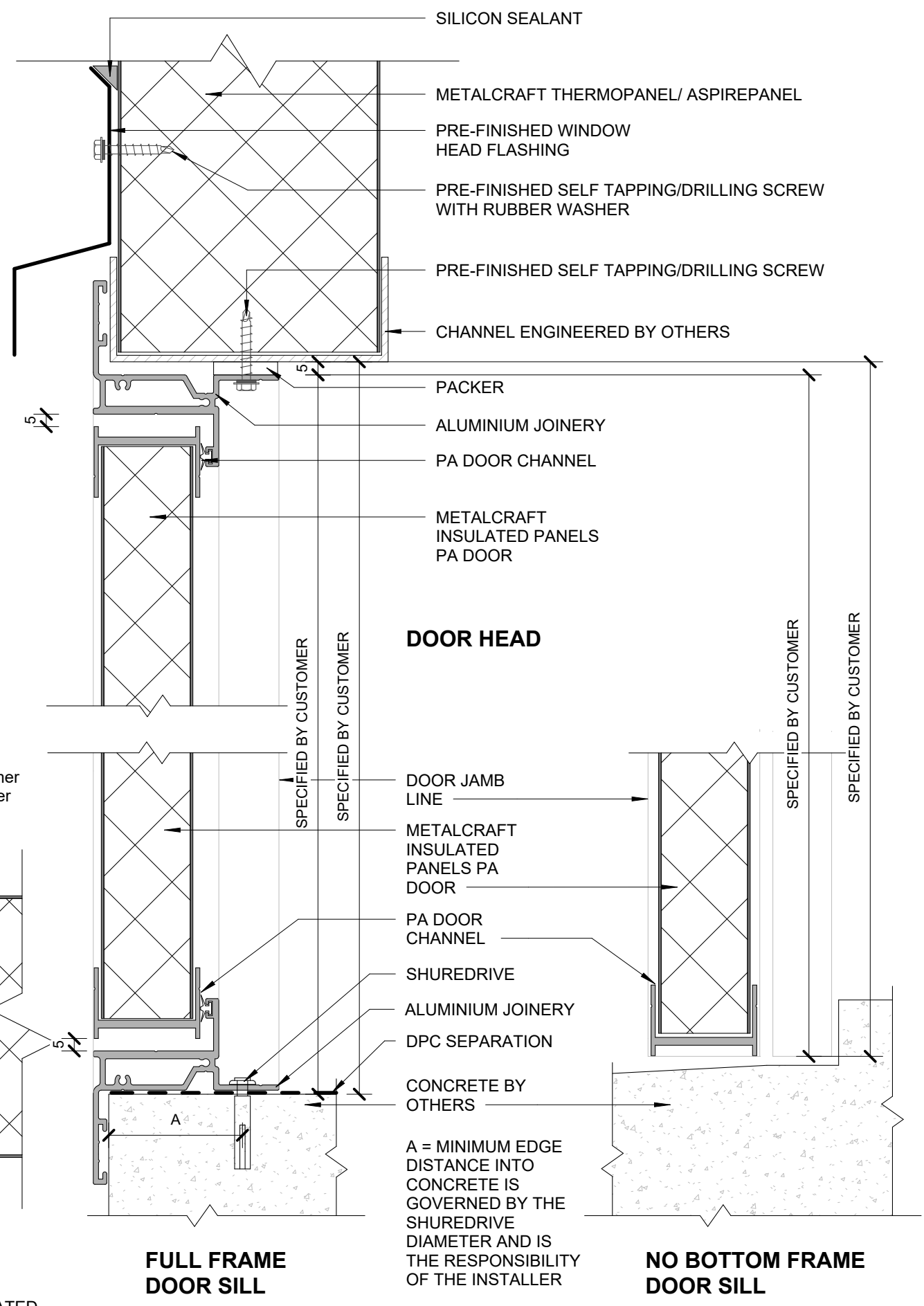
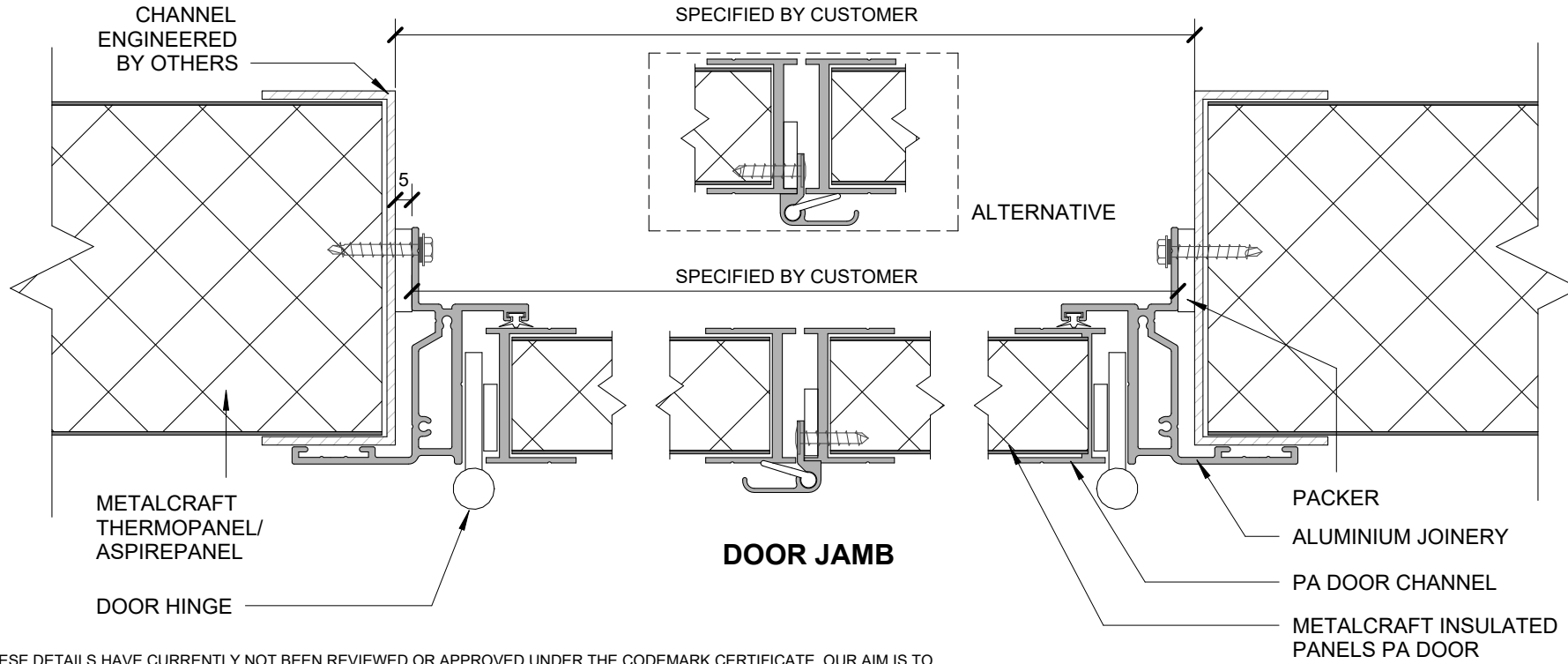

THESE DETAILS HAVE CURRENTLY NOT BEEN REVIEWED OR APPROVED UNDER THE CODEMARK CERTIFICATE. OUR AIM IS TO OBTAIN APPROVAL FOR THESE DETAILS AT A FUTURE DATE. PLEASE CONSULT METALCRAFT INSULATED PANELS.

DISCLAIMER:
All details are to be used for indicative purposes only. Details of the supporting mechanisms are indicative only and require engineering by others. Compliance of the supporting mechanisms is the responsibility of the designer. Construction detail can vary for wall cladding. The underlay is detailed as a single line for simplicity and is indicative only. Building paper type and method of installation should comply with underlay manufacturers recommendations and NZBC regulations.

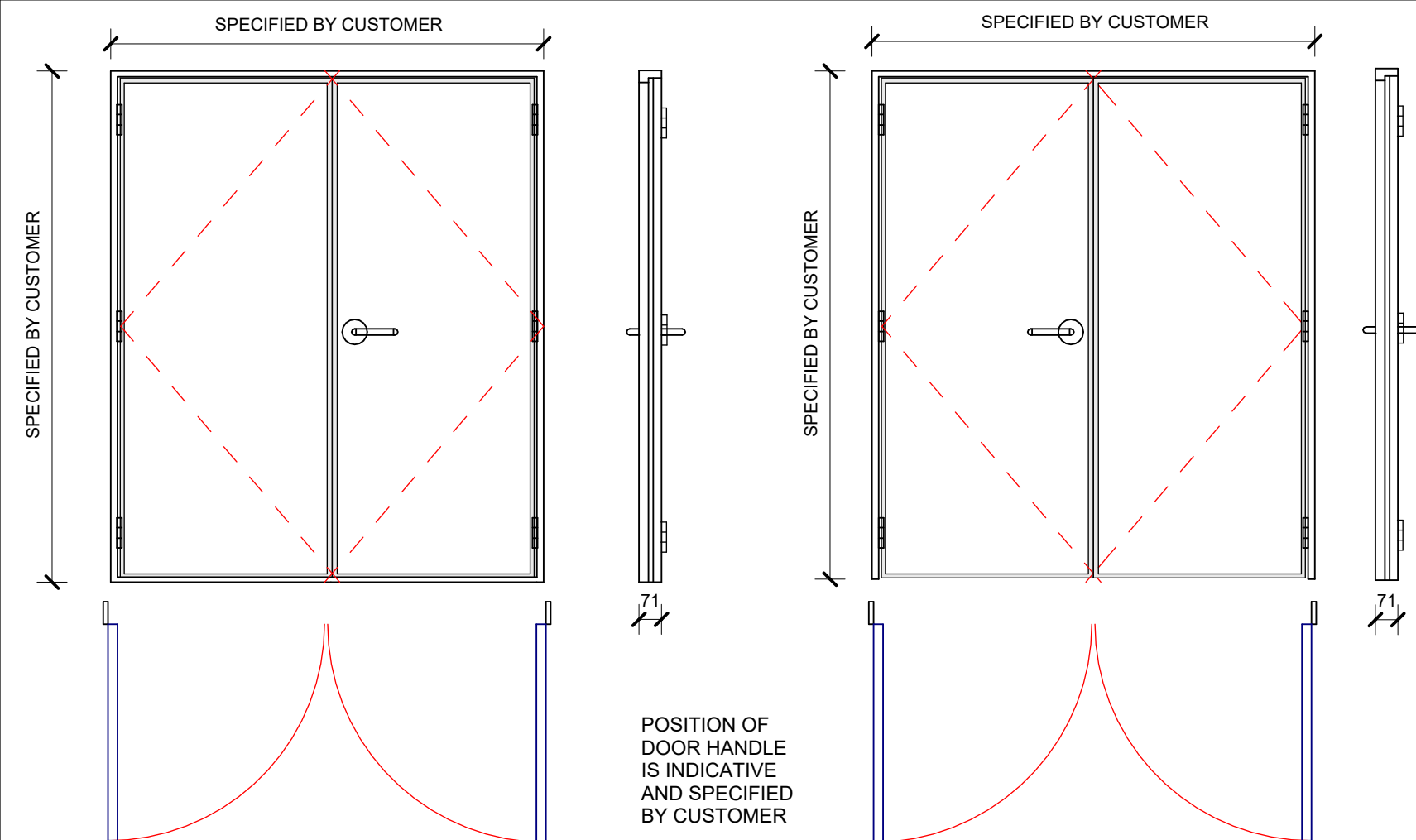

STANDARD DOOR FULL FRAME - RIGHT HAND

CUT SIZE (HOLE IN THE WALL)
HEIGHT = Specified By Customer
WIDTH = Specified By Customer

BOX SIZE
HEIGHT = Specified By Customer
WIDTH = Specified By Customer

STANDARD DOOR NO BOTTOM FRAME - LEFT HAND

CUT SIZE (HOLE IN THE WALL)
HEIGHT = Specified By Customer
WIDTH = Specified By Customer

BOX SIZE
HEIGHT = Specified By Customer
WIDTH = Specified By Customer

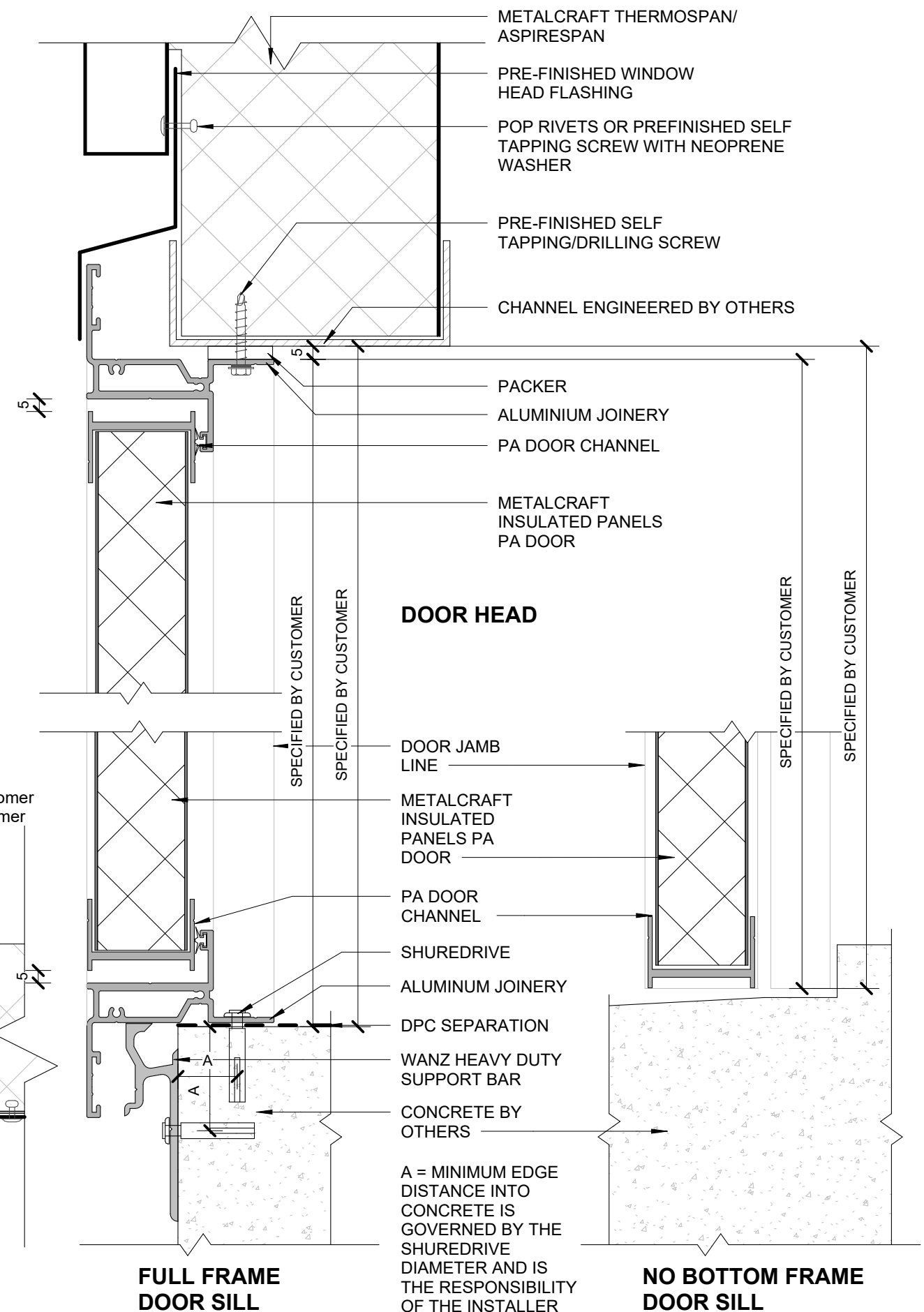
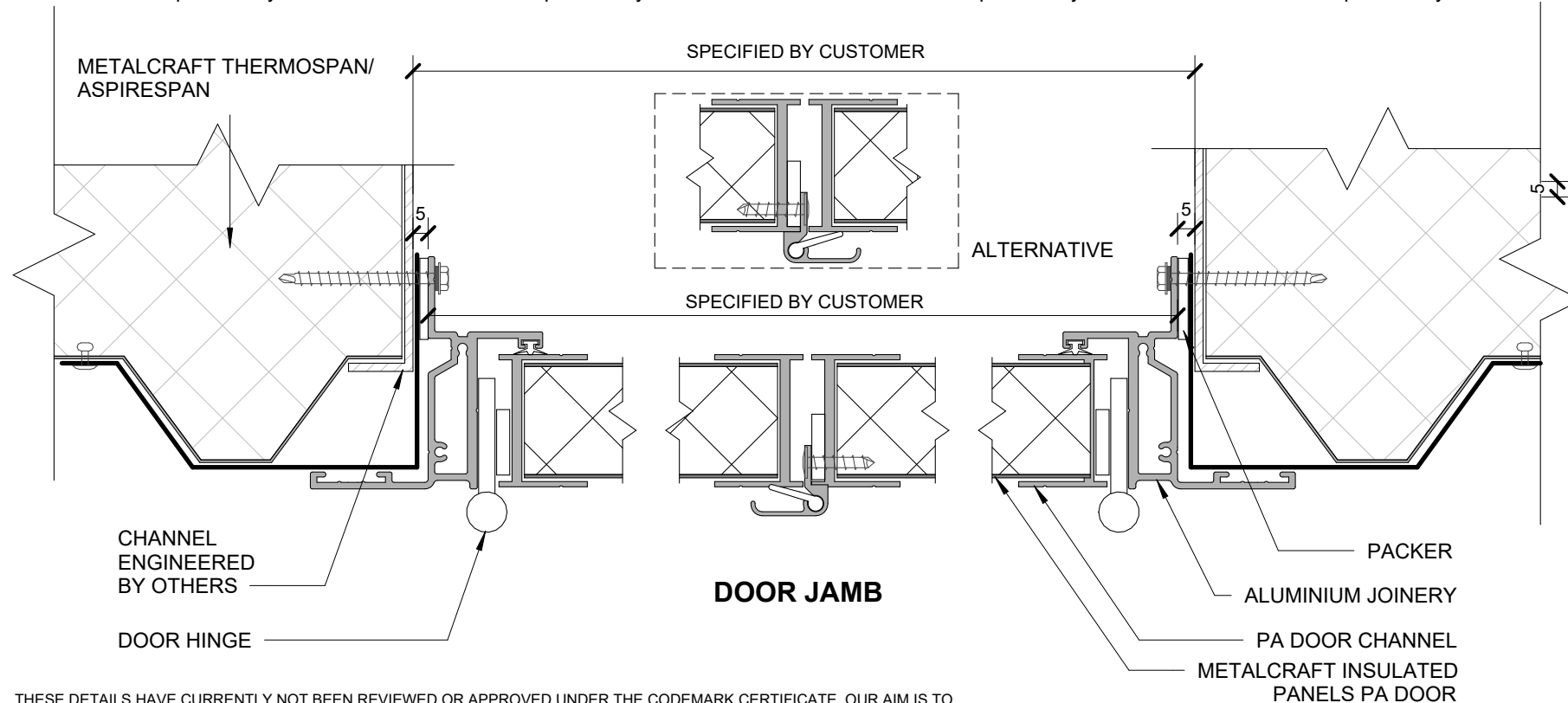

THESE DETAILS HAVE CURRENTLY NOT BEEN REVIEWED OR APPROVED UNDER THE CODEMARK CERTIFICATE. OUR AIM IS TO OBTAIN APPROVAL FOR THESE DETAILS AT A FUTURE DATE. PLEASE CONSULT METALCRAFT INSULATED PANELS.

Metalcraft
Insulated Panels
www.metalcraftgroup.co.nz

DISCLAIMER:
All details are to be used for indicative purposes only. Details of the supporting mechanisms are indicative only and require engineering by others. Compliance of the supporting mechanisms is the responsibility of the designer. Construction detail can vary for wall cladding. The underlay is detailed as a single line for simplicity and is indicative only. Building paper type and method of installation should comply with underlay manufacturers recommendations and NZBC regulations.

OUTWARDS OPENING DOOR DETAIL - INSULATED TRAPEZOIDAL PANEL

PA Double Doors

Rev. 1.1

PA DOOR DETAIL ON INSULATED PANELS

Reference PADDIP

Date JUNE 2025

Scale 1:25 AND 1:2

Sheet

02 / 04

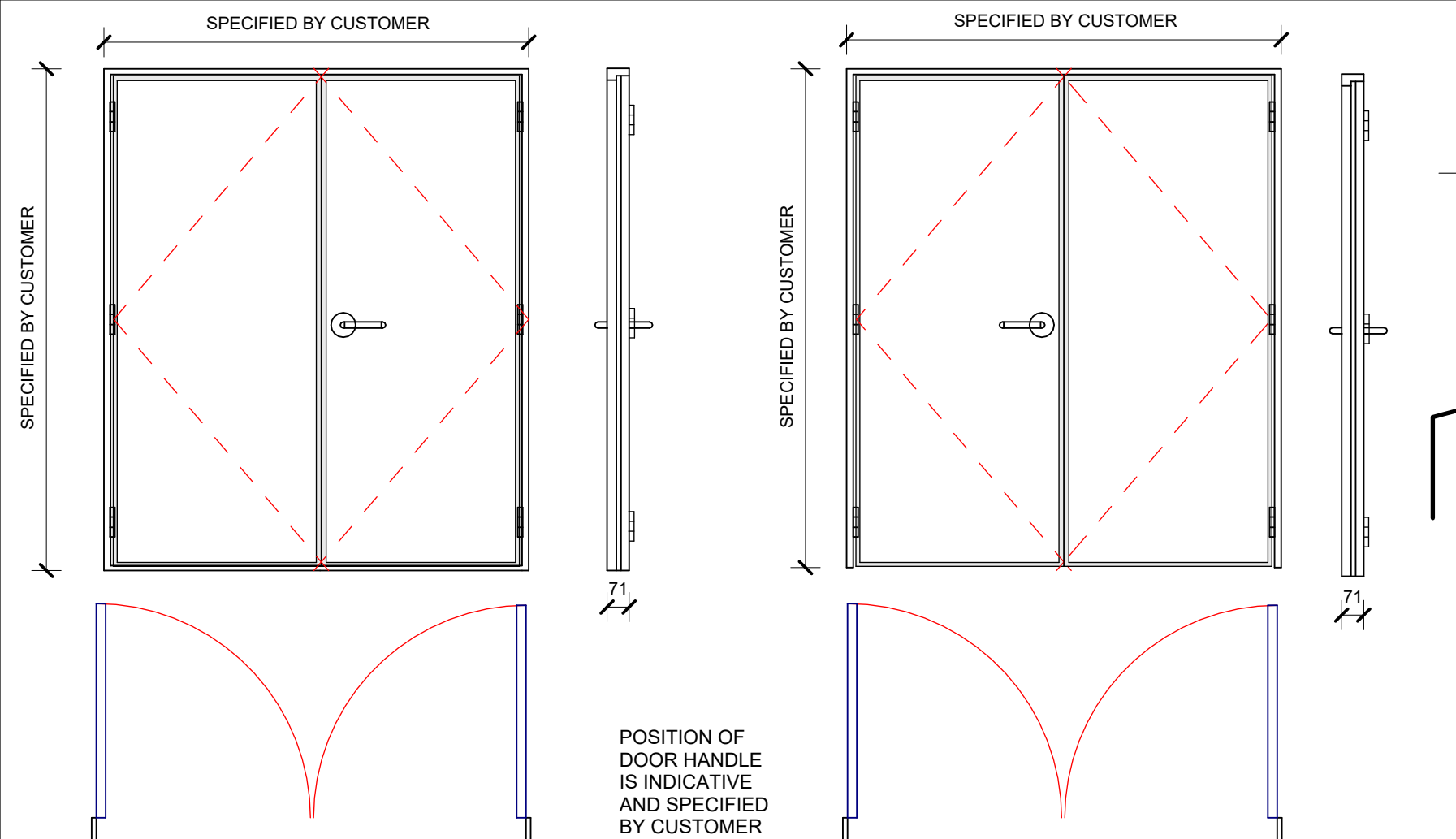

**STANDARD DOOR
FULL FRAME - RIGHT HAND**

CUT SIZE (HOLE IN THE WALL)
HEIGHT = Specified By Customer
WIDTH = Specified By Customer

BOX SIZE
HEIGHT = Specified By Customer
WIDTH = Specified By Customer

**STANDARD DOOR
NO BOTTOM FRAME - LEFT HAND**

CUT SIZE (HOLE IN THE WALL)
HEIGHT = Specified By Customer
WIDTH = Specified By Customer

BOX SIZE
HEIGHT = Specified By Customer
WIDTH = Specified By Customer

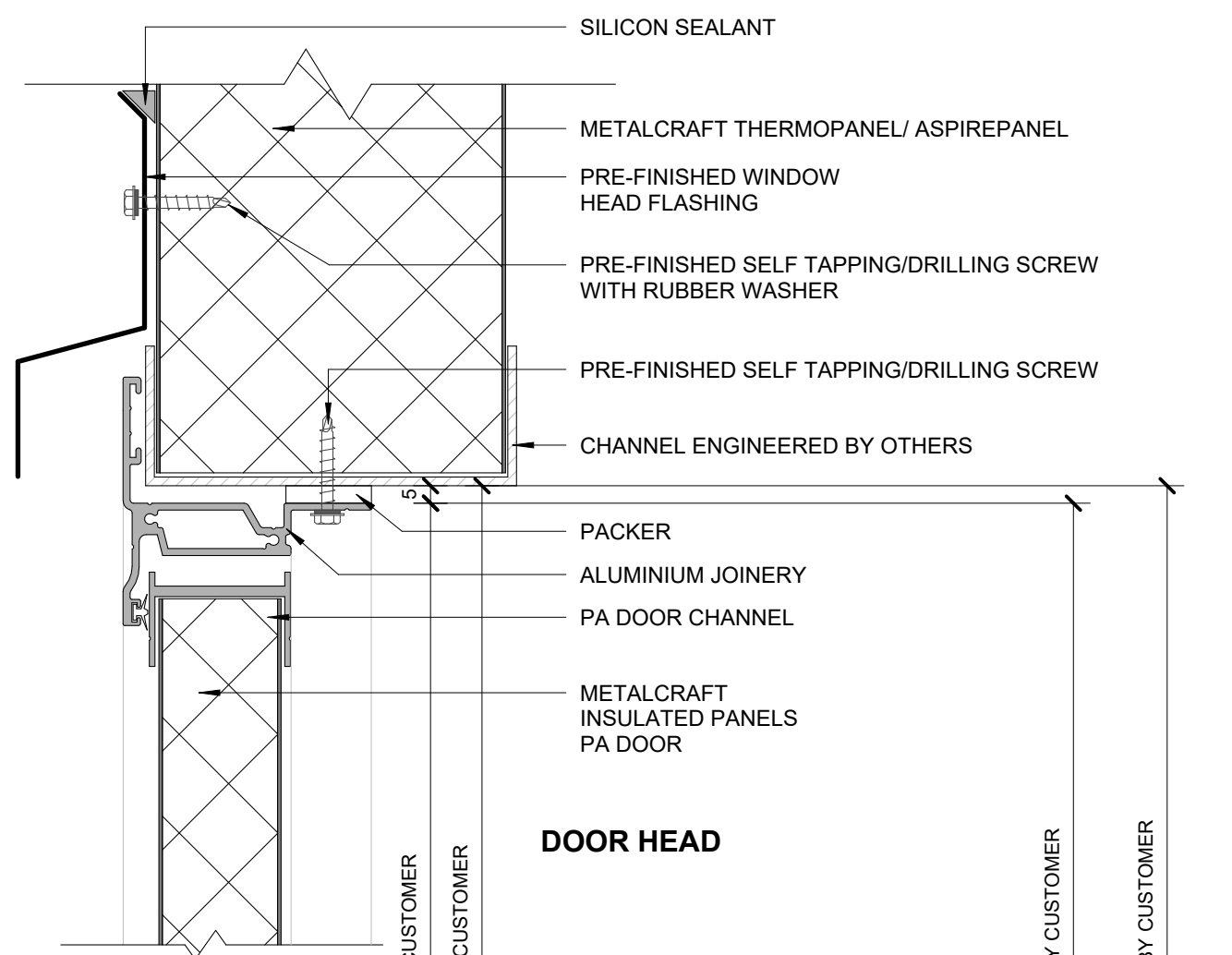

DOOR HEAD

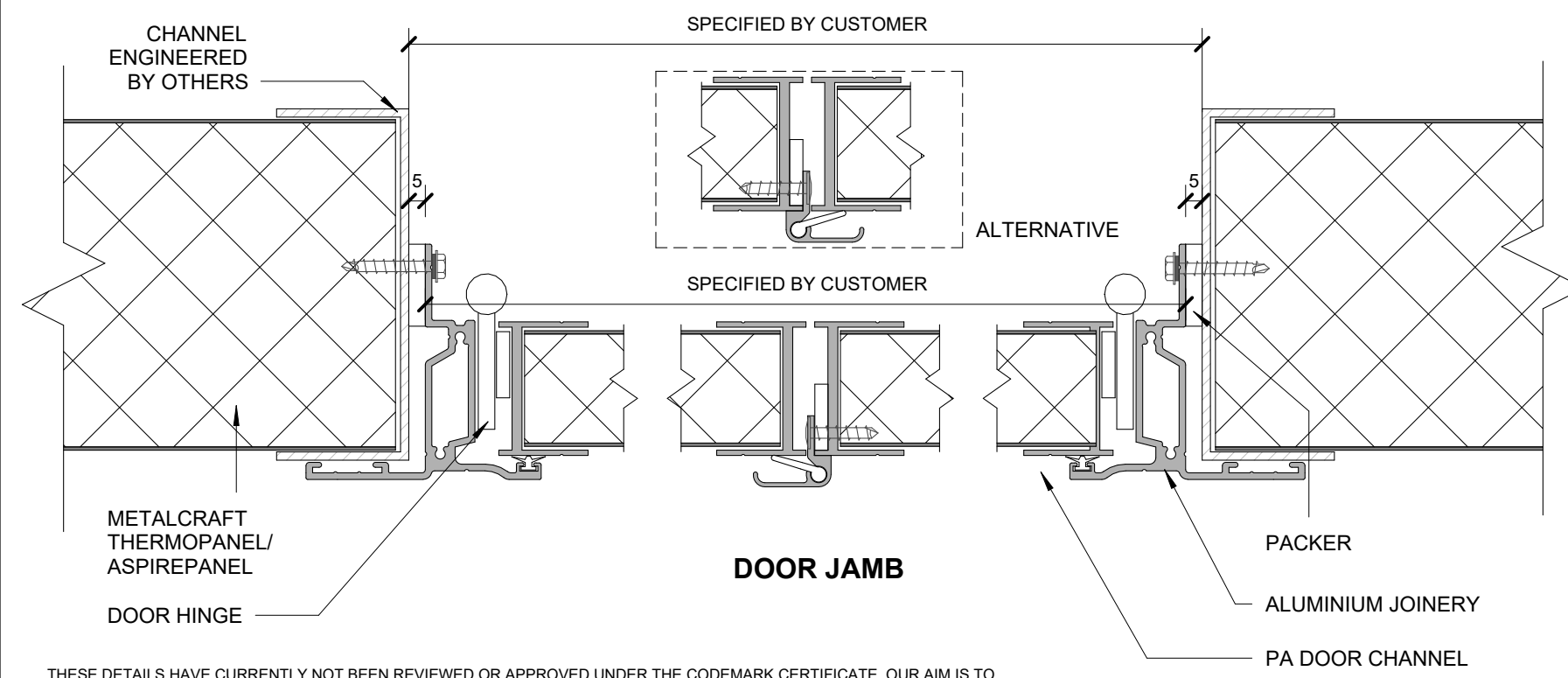

DOOR JAMB

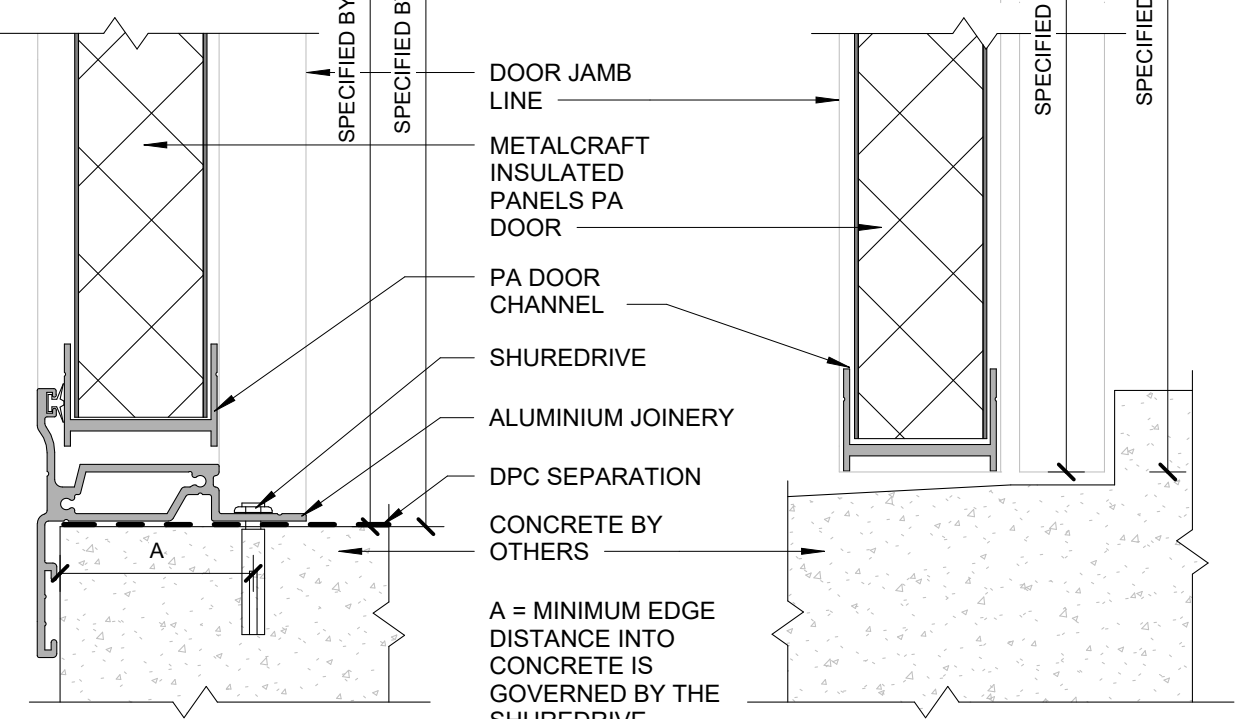

**FULL FRAME
DOOR SILL**

**NO BOTTOM FRAME
DOOR SILL**

THESE DETAILS HAVE CURRENTLY NOT BEEN REVIEWED OR APPROVED UNDER THE CODEMARK CERTIFICATE. OUR AIM IS TO OBTAIN APPROVAL FOR THESE DETAILS AT A FUTURE DATE. PLEASE CONSULT METALCRAFT INSULATED PANELS.

DISCLAIMER:
All details are to be used for indicative purposes only. Details of the supporting mechanisms are indicative only and require engineering by others. Compliance of the supporting mechanisms is the responsibility of the designer. Construction detail can vary for wall cladding. The underlay is detailed as a single line for simplicity and is indicative only. Building paper type and method of installation should comply with underlay manufacturers recommendations and NZBC regulations.

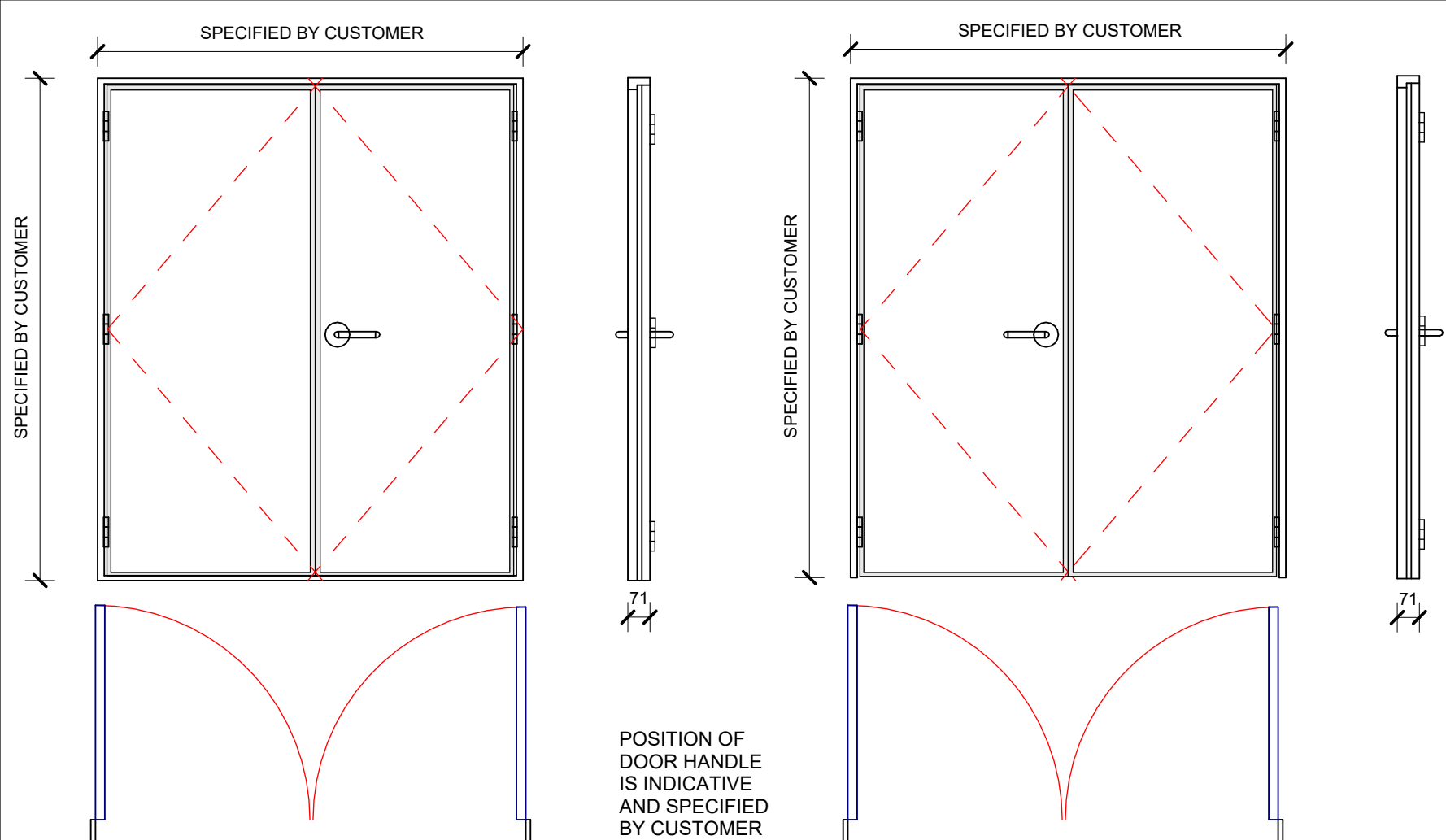

STANDARD DOOR FULL FRAME - RIGHT HAND

CUT SIZE (HOLE IN THE WALL)
HEIGHT = Specified By Customer
WIDTH = Specified By Customer

BOX SIZE
HEIGHT = Specified By Customer
WIDTH = Specified By Customer

STANDARD DOOR NO BOTTOM FRAME - LEFT HAND

CUT SIZE (HOLE IN THE WALL)
HEIGHT = Specified By Customer
WIDTH = Specified By Customer

BOX SIZE
HEIGHT = Specified By Customer
WIDTH = Specified By Customer

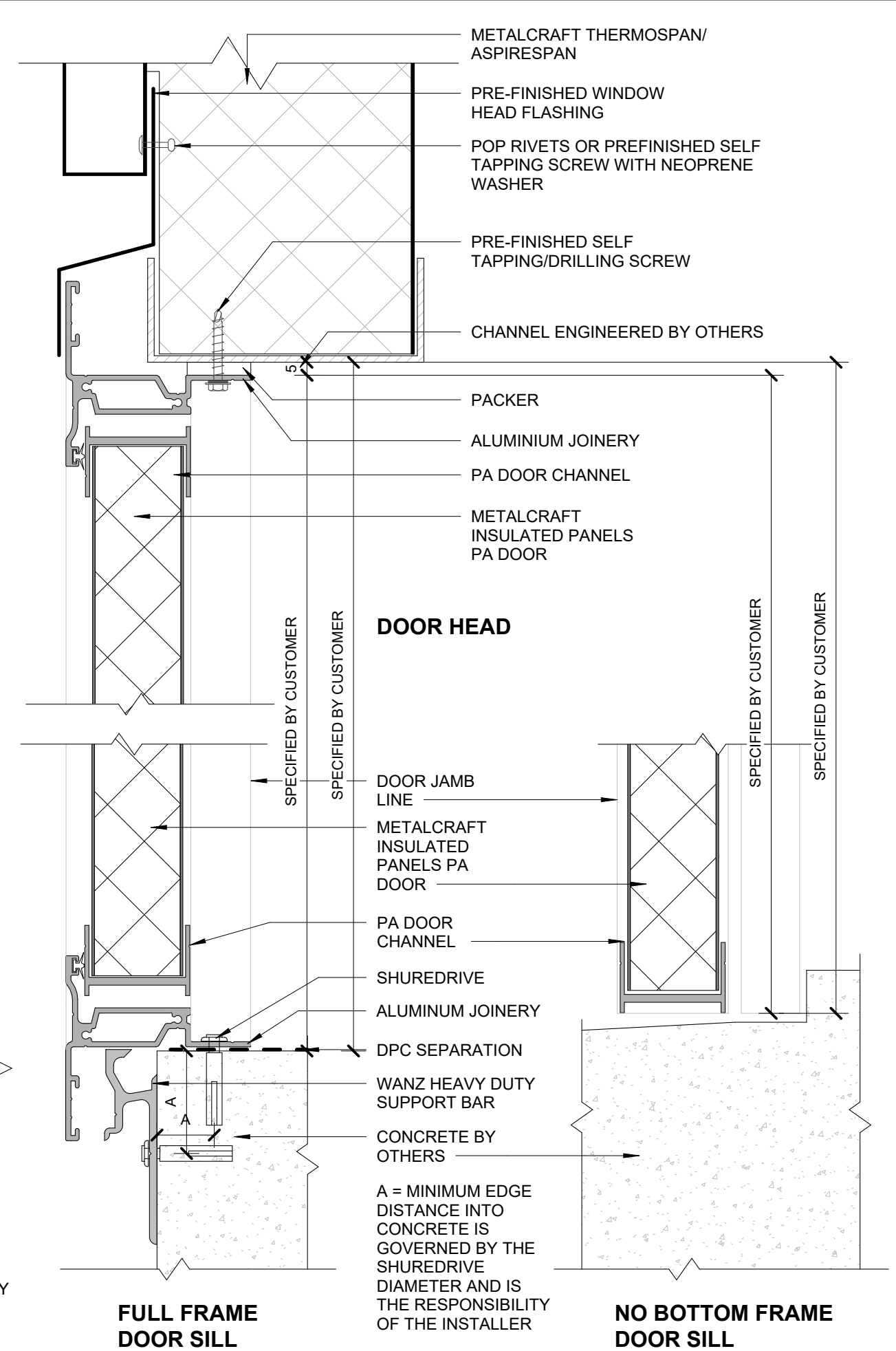
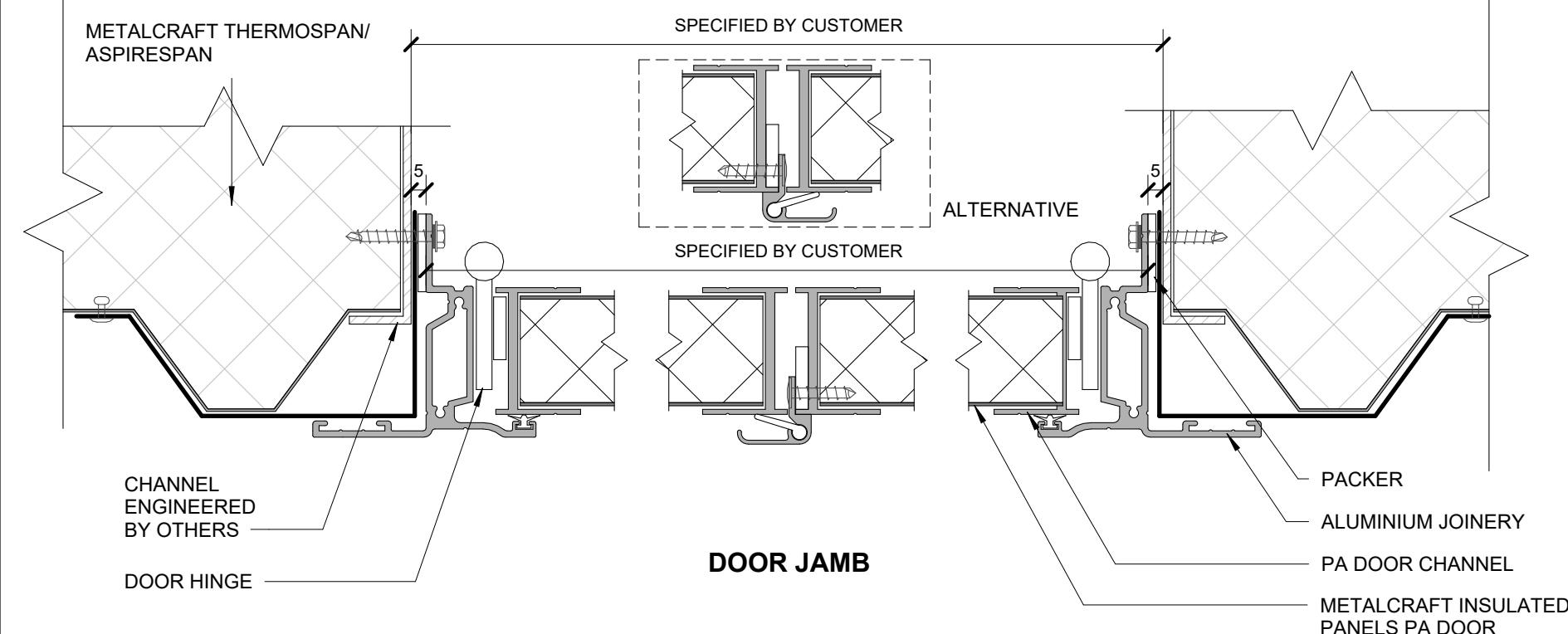

THESE DETAILS HAVE CURRENTLY NOT BEEN REVIEWED OR APPROVED UNDER THE CODEMARK CERTIFICATE. OUR AIM IS TO OBTAIN APPROVAL FOR THESE DETAILS AT A FUTURE DATE. PLEASE CONSULT METALCRAFT INSULATED PANELS.

DISCLAIMER:
All details are to be used for indicative purposes only. Details of the supporting mechanisms are indicative only and require engineering by others. Compliance of the supporting mechanisms is the responsibility of the designer. Construction detail can vary for wall cladding. The underlay is detailed as a single line for simplicity and is indicative only. Building paper type and method of installation should comply with underlay manufacturers recommendations and NZBC regulations.